

## STEPS

(1) Hardware

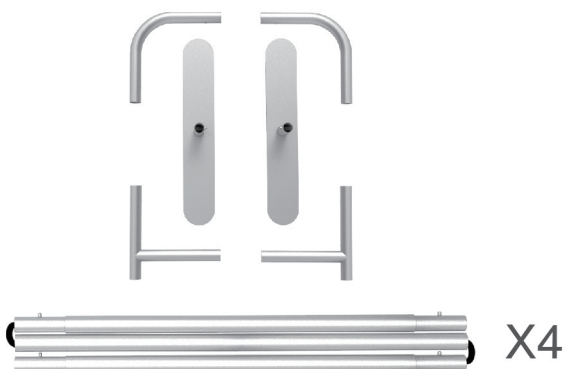

(2) Graphic printing fabric banner



## STEP 01

To connect the poles according to the labellings

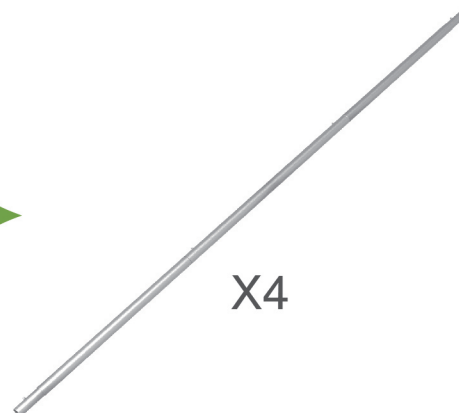
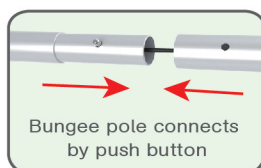
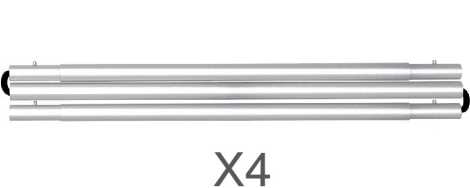

## STEP 02

To use corner pieces to connect the poles to be display stand

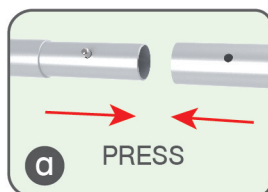
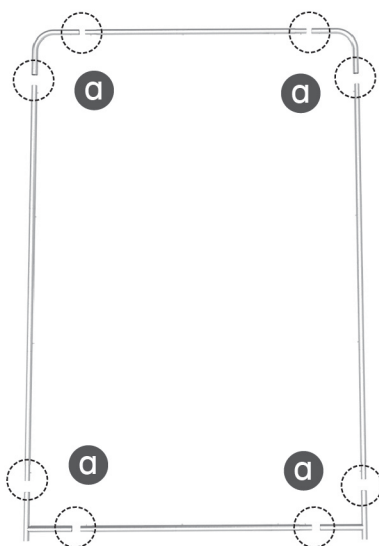

## STEPS

## STEP 03

To slide the fabric banner on the frame from top and zip up at bottom

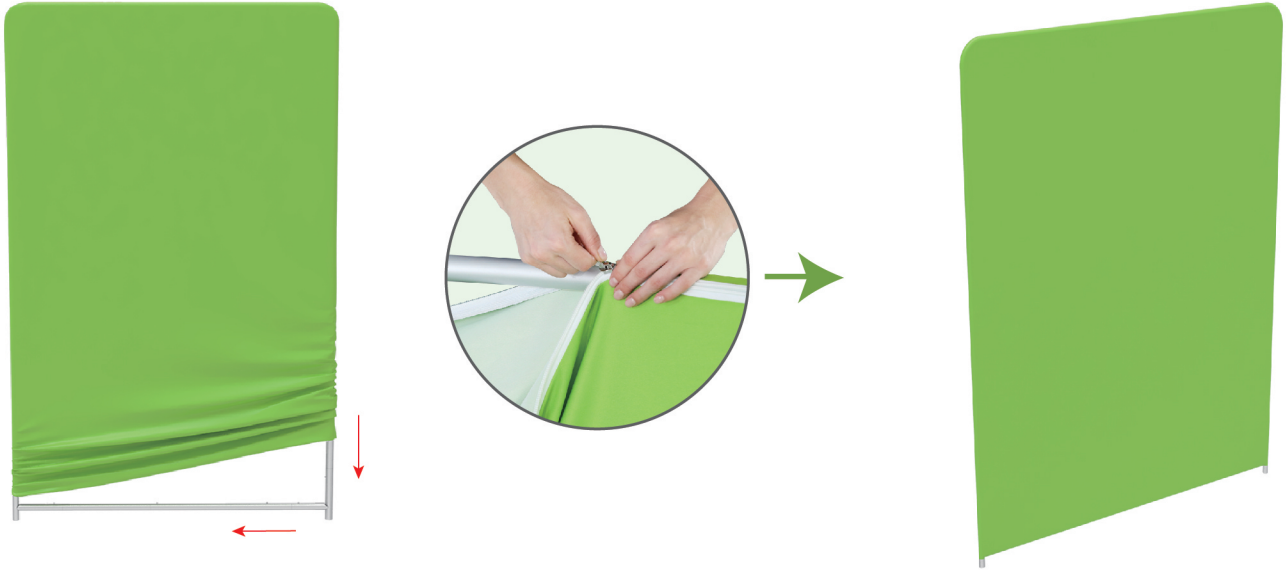

## STEP 04

To assemble the stand feet in position

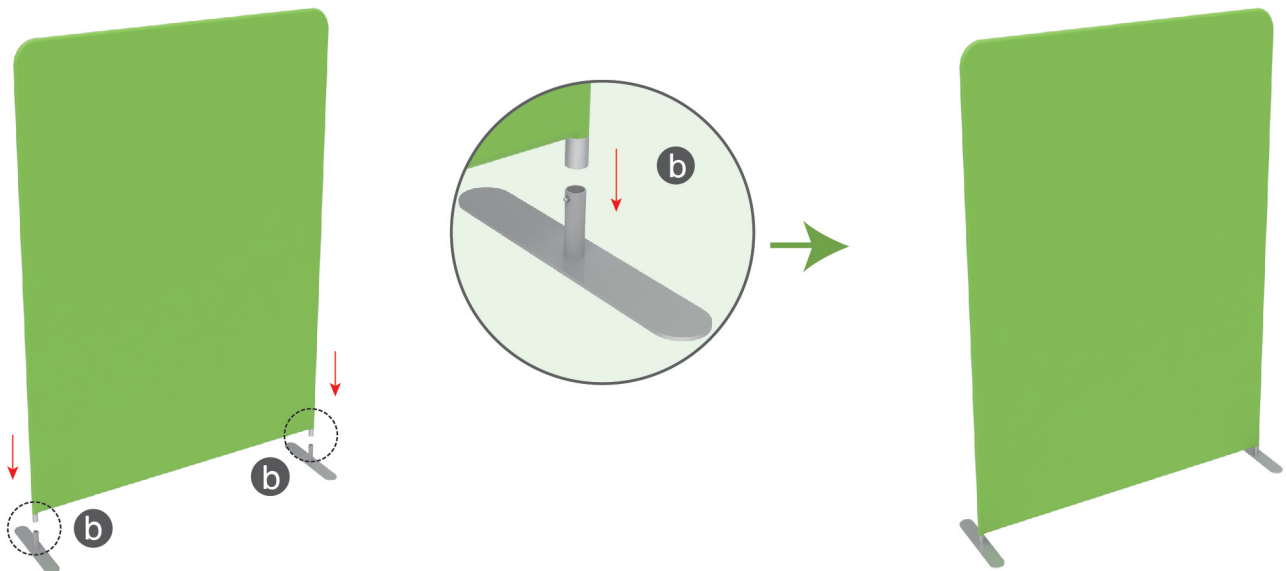

## STEPS

(1) Hardware

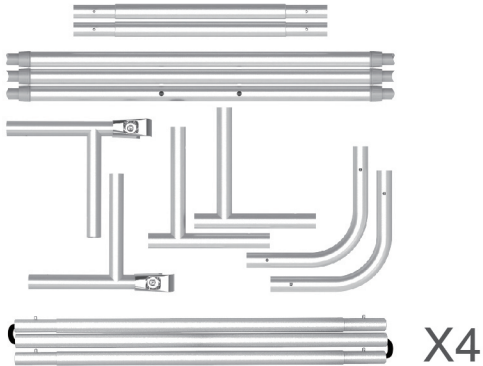

(2) Graphic printing fabric banner



## STEP 01

To connect the poles according to the labellings

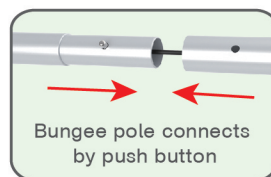

## STEP 02

To use corner pieces to connect the poles to be display stand

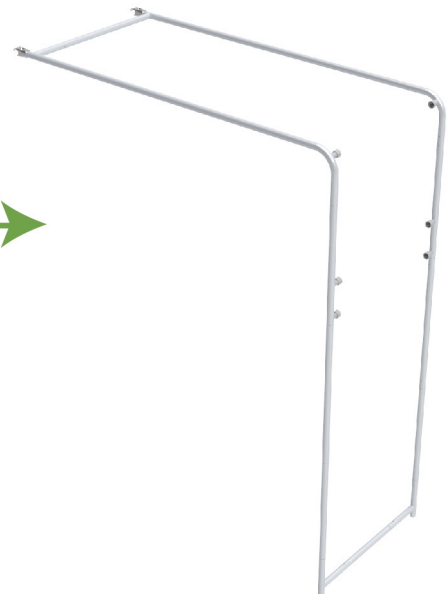
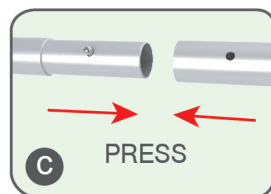
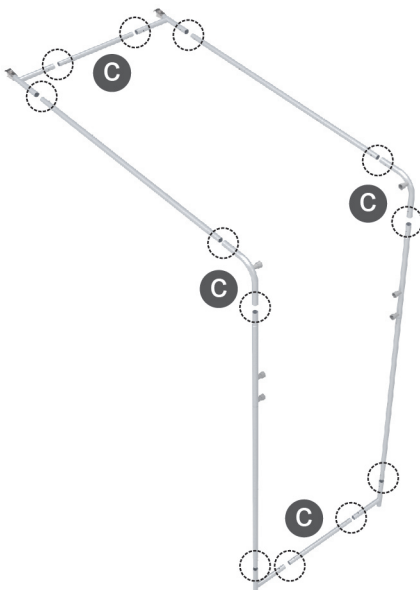

## STEPS

## STEP 03

To install the cross bar according to the labellings

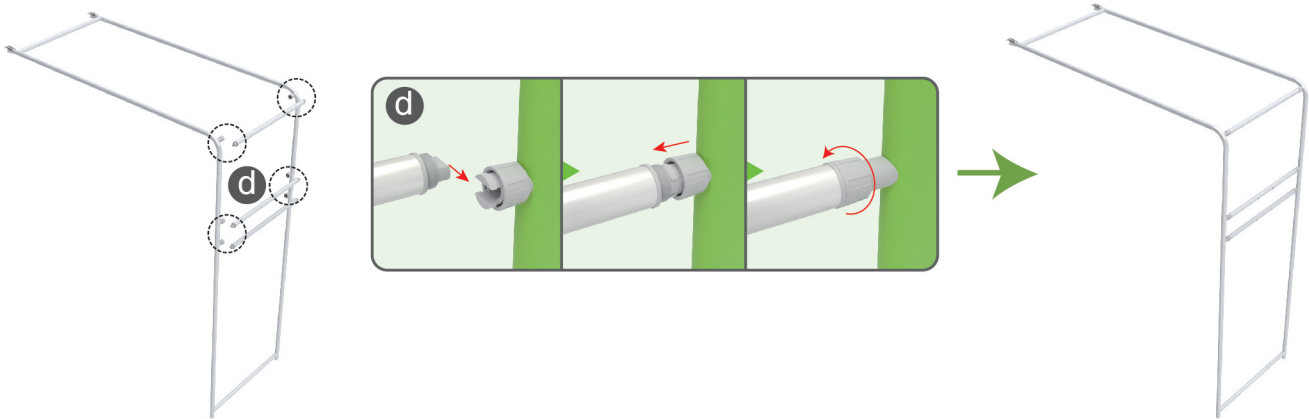

## STEP 04

To lie down the stand and wrap the fabric banner from side to side and zip up

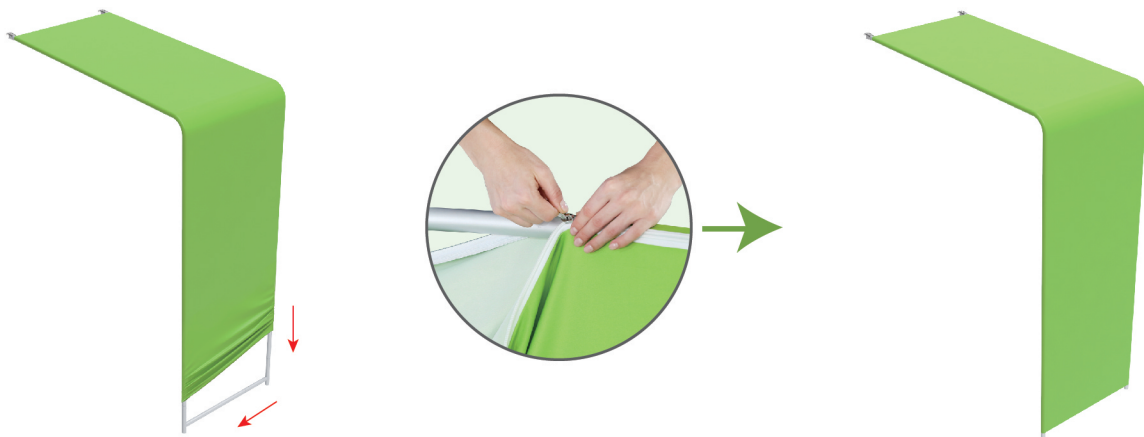

## STEP 05

To assemble the feet in position

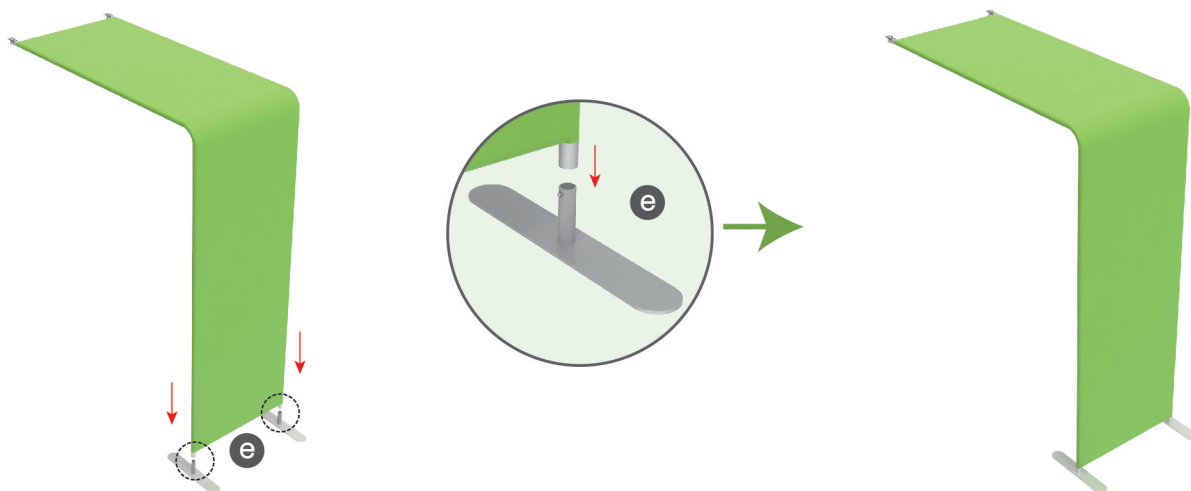



## STEPS

## (1) Hardware



## (2) Graphic printing fabric banner



## STEP 01

To connect the poles according to the labellings

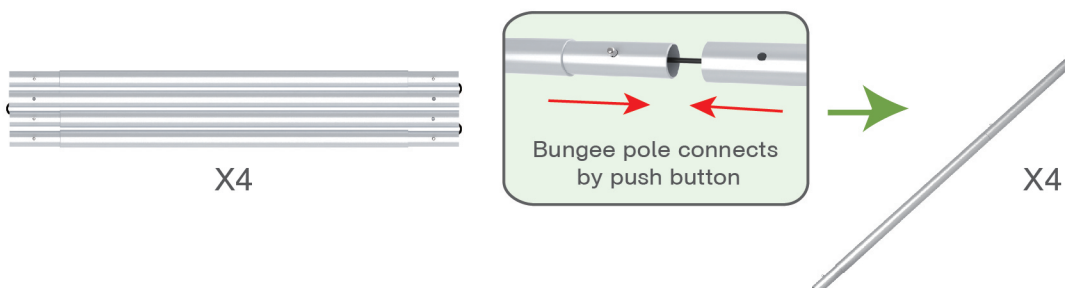

## STEP 02

To use corner pieces to connect the poles to be display stand

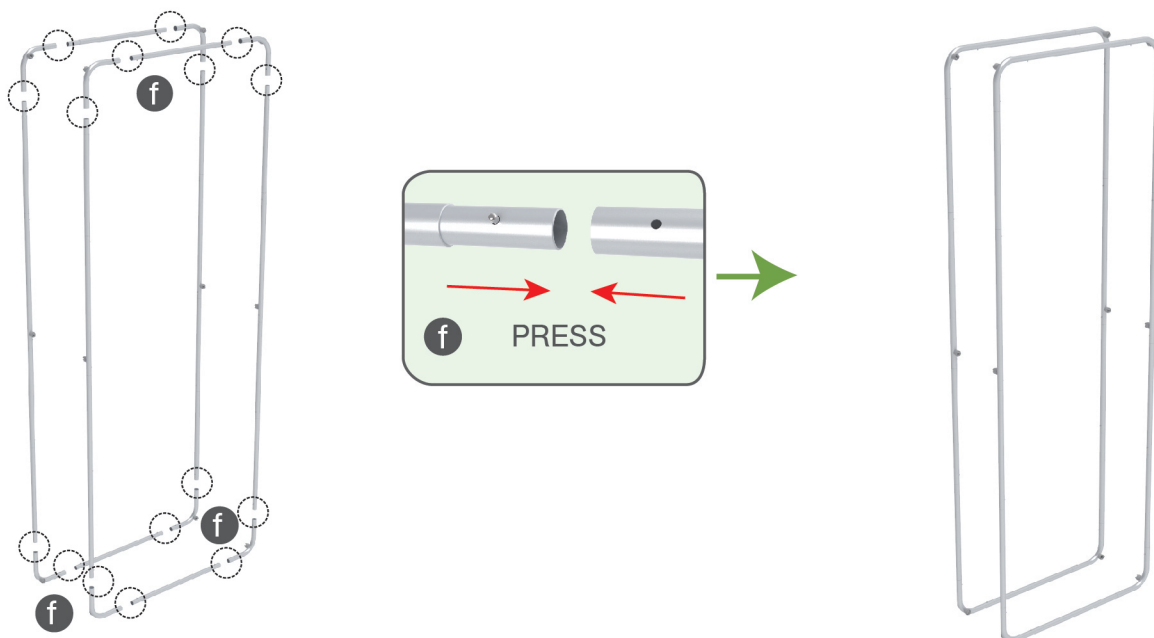

## STEPS

## STEP 03

To install the cross bar according to the labellings

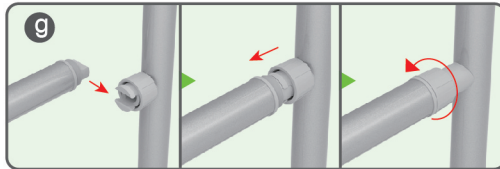
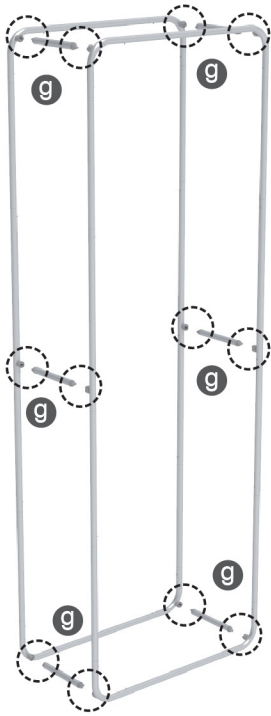

## STEP 04

To lie down the stand and wrap the fabric banner from side to side and zip up

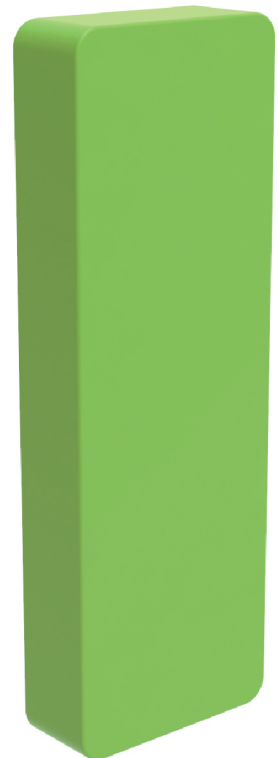
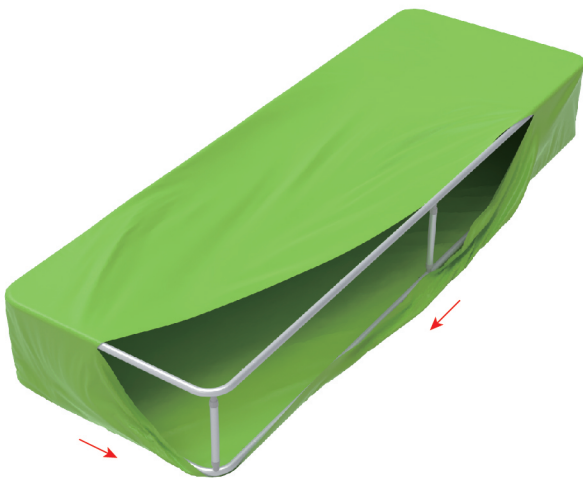



## STEPS

## STEP 03

To install the cross bar according to the labellings

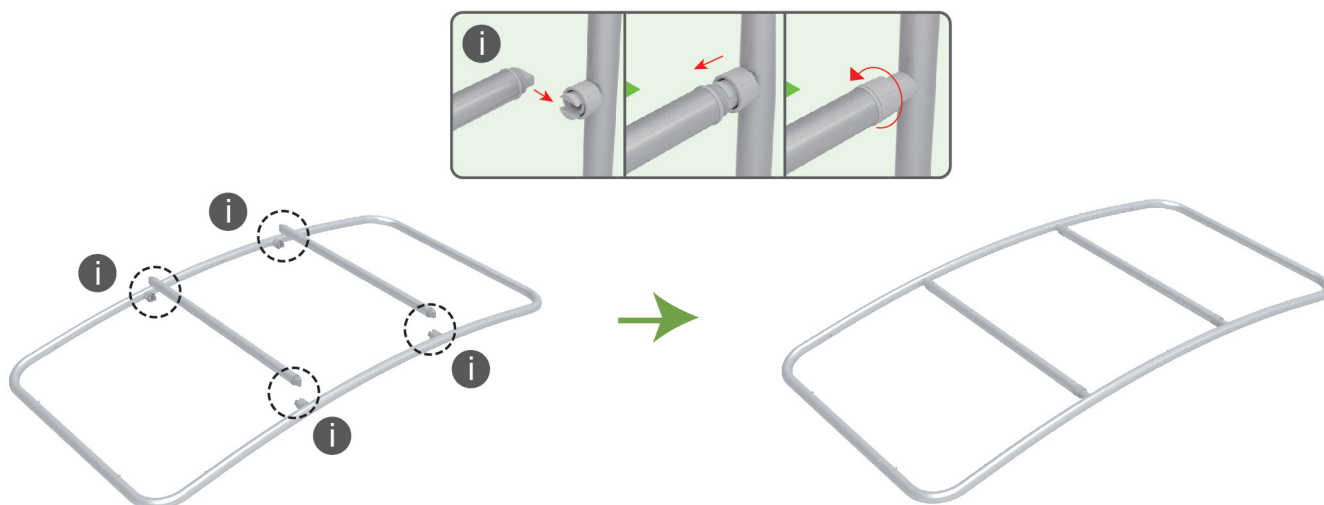

## STEP 04

To slide over the fabric banner from side to side and zip up

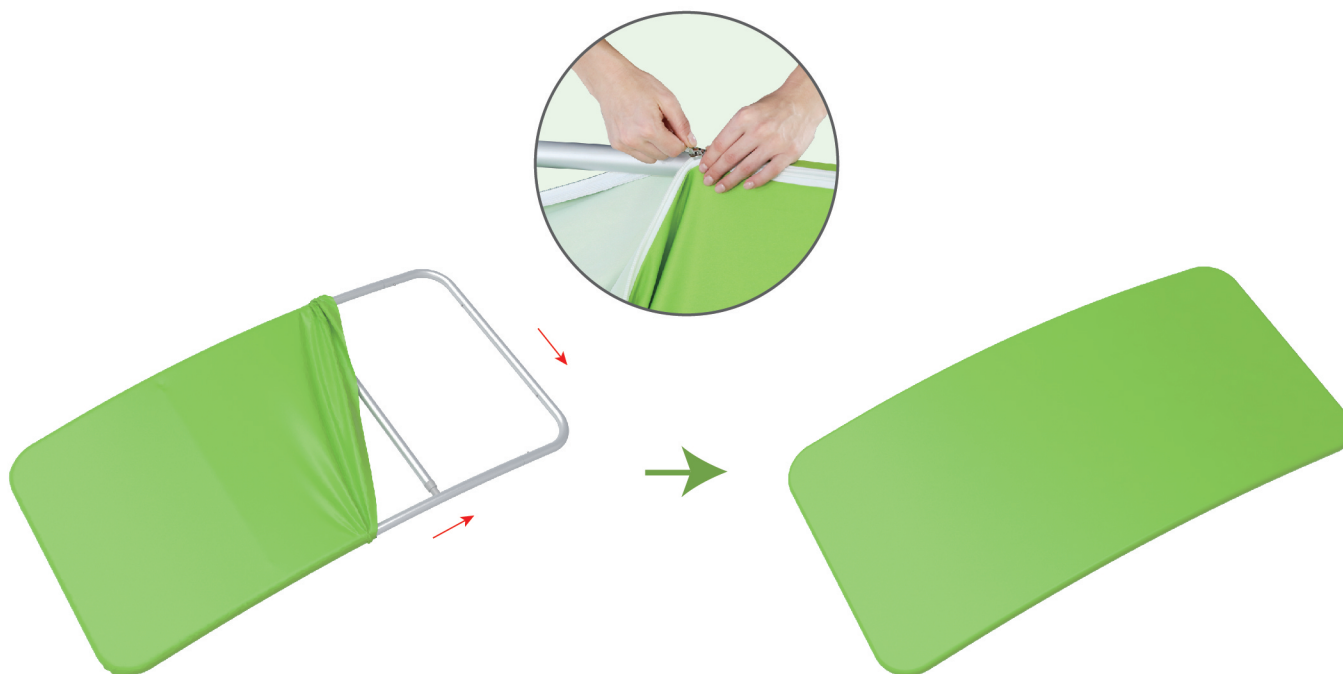

### STEPS

#### Booth Set Assembly

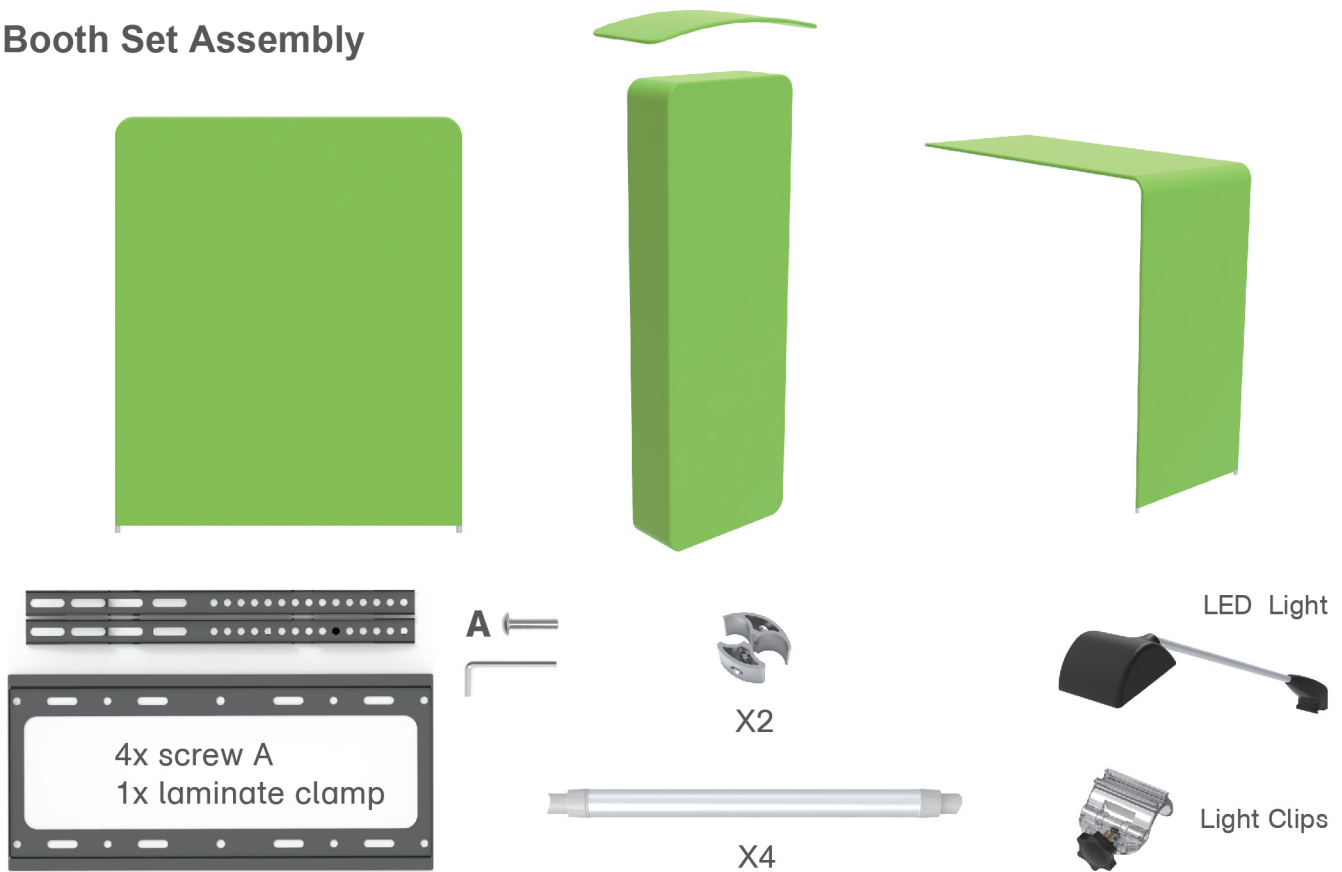

#### STEP 01

To lie down the column and install the roof onto it by using 4 upright poles

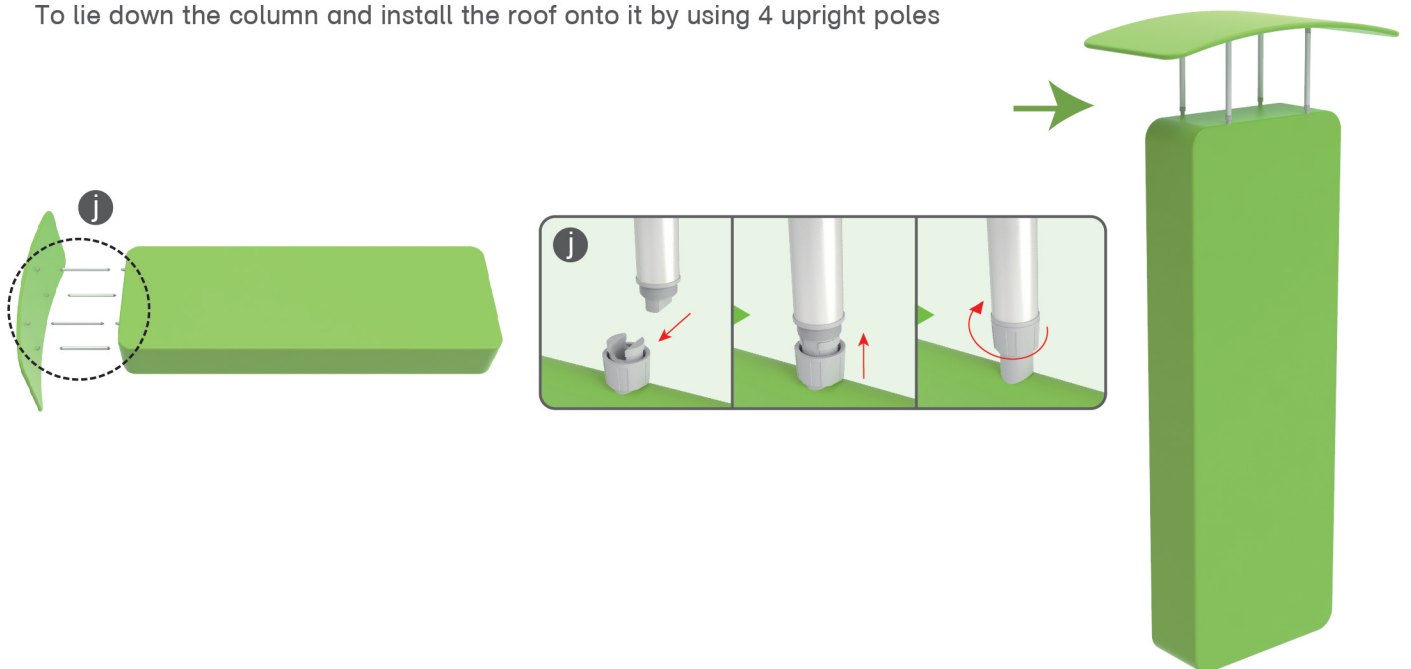

## STEPS

## STEP 02

To use C clip to connect the backwall with the column perfectly

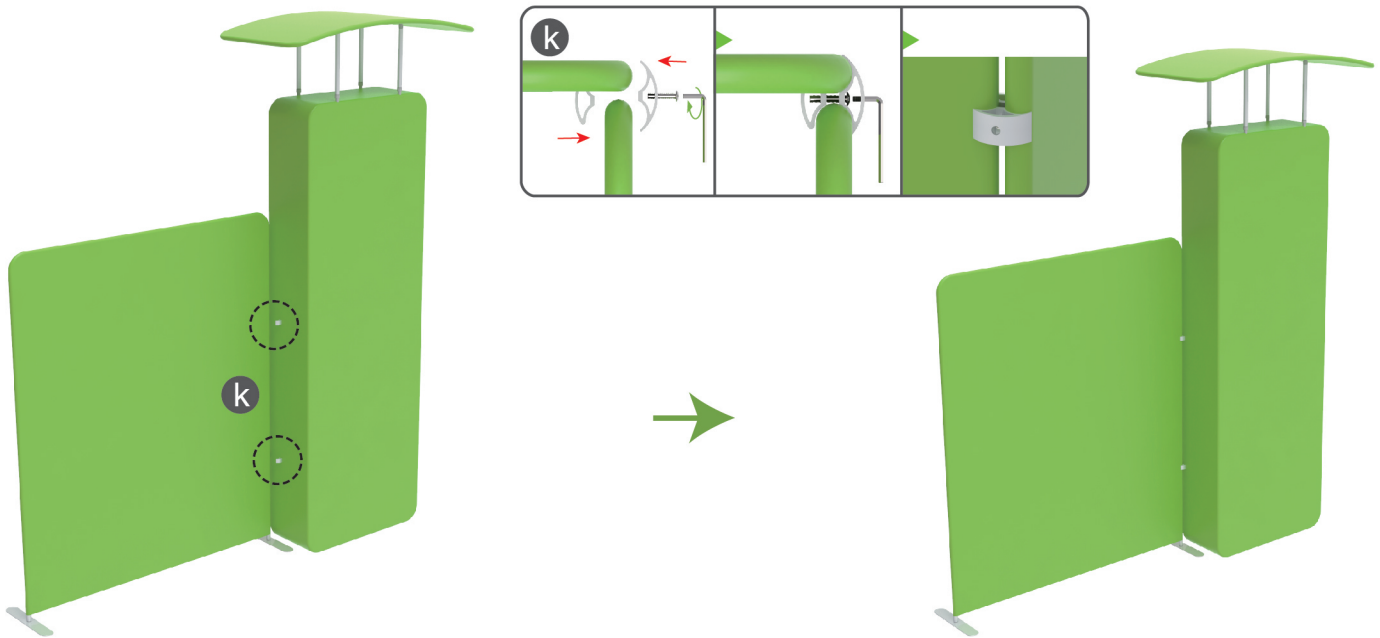

## STEP 03

To use the clamp to install the arch stand to column

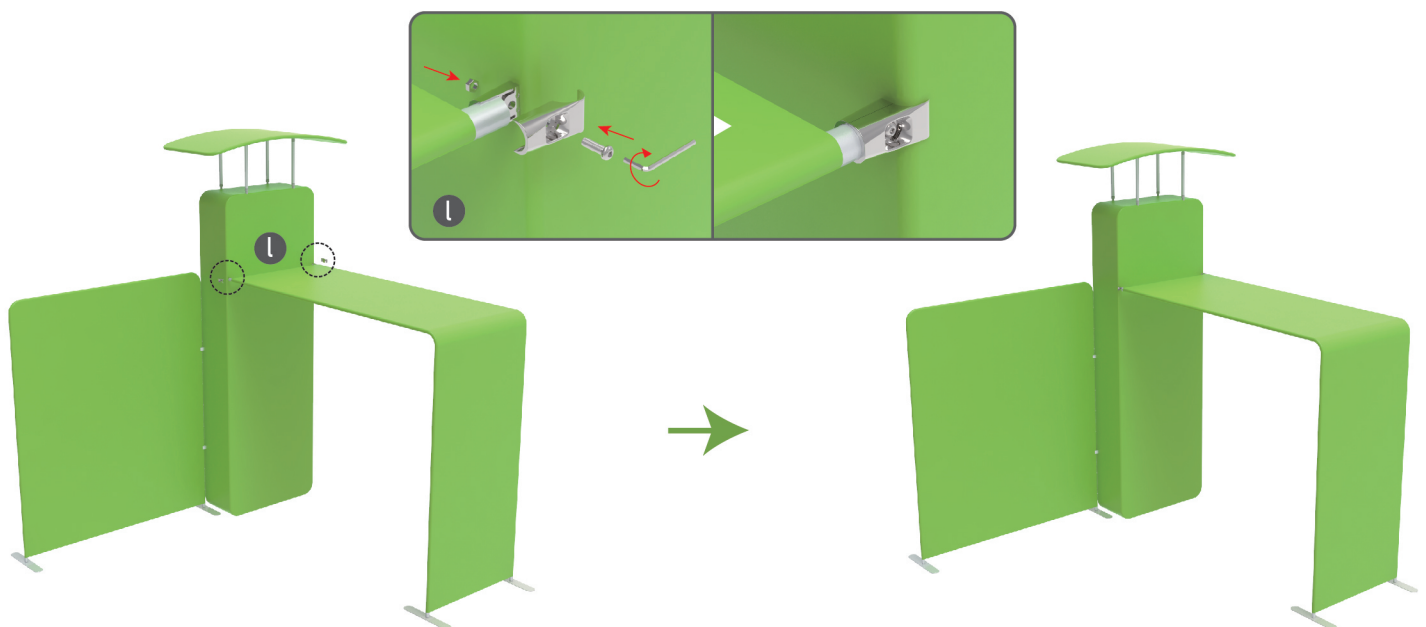



### STEPS

#### STEP 04

To install the TV mount in position

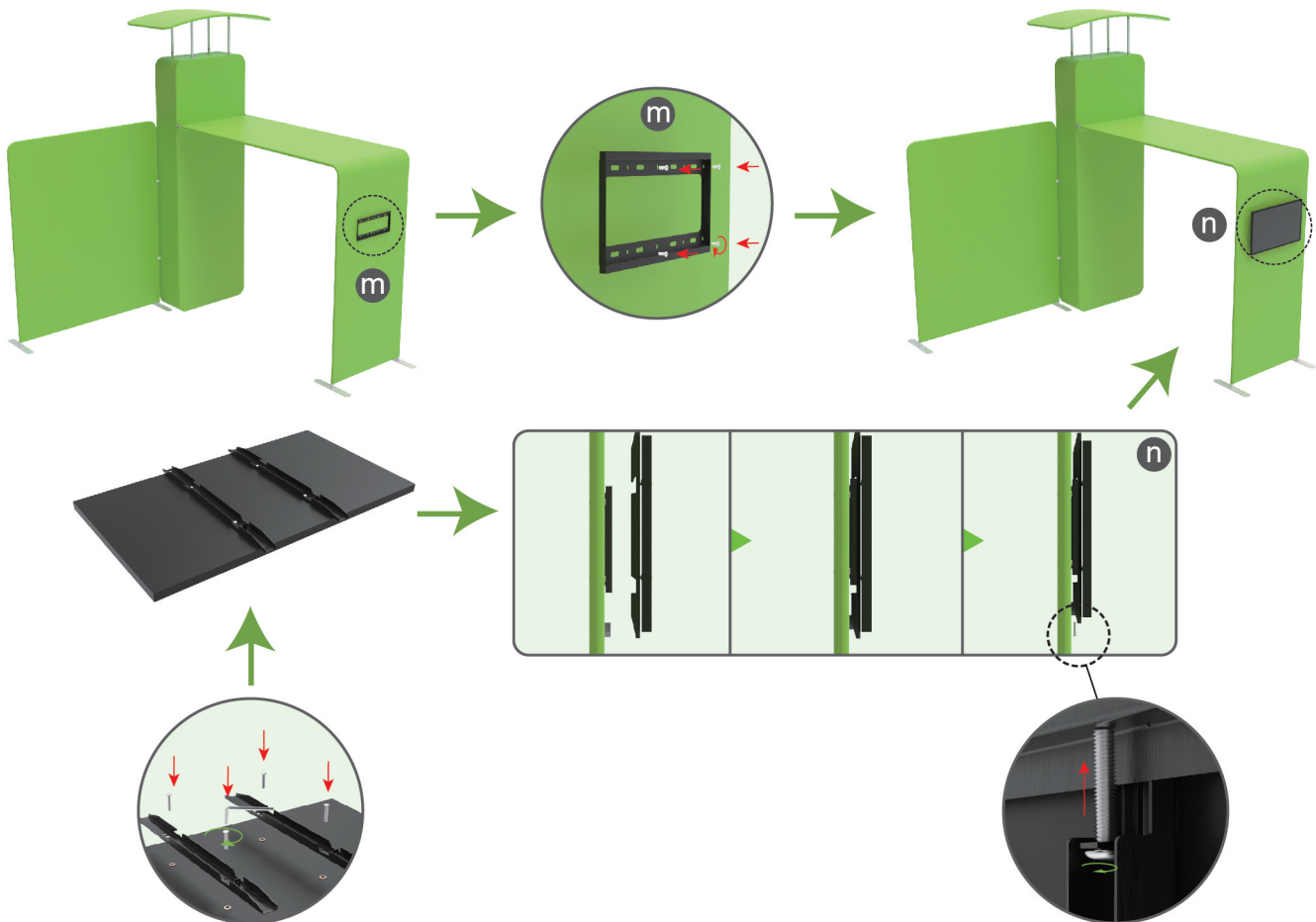

#### STEP 05

Install LED light

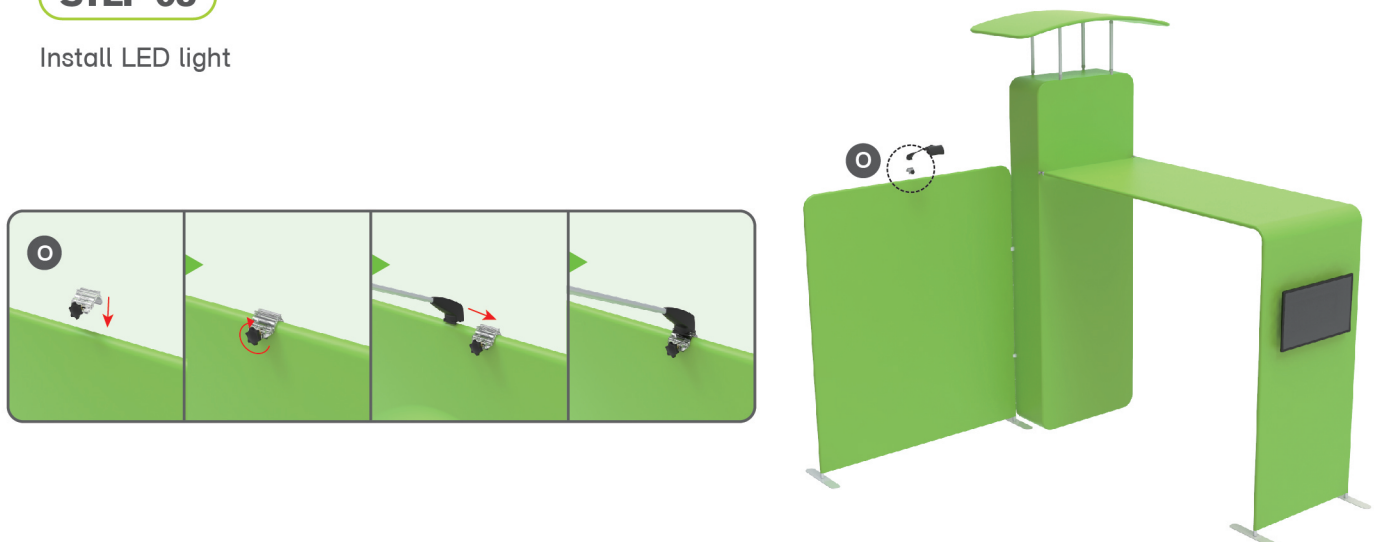



### STEPS

Same Assembly Steps for Following Booths



10X10FT-BOOTH-07

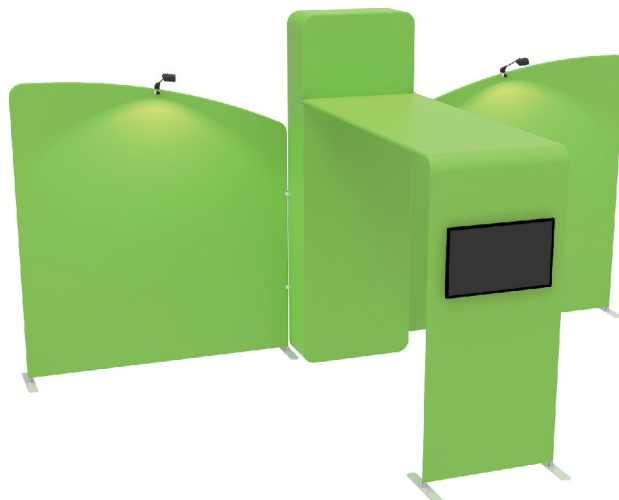

10X20FT-BOOTH-Q

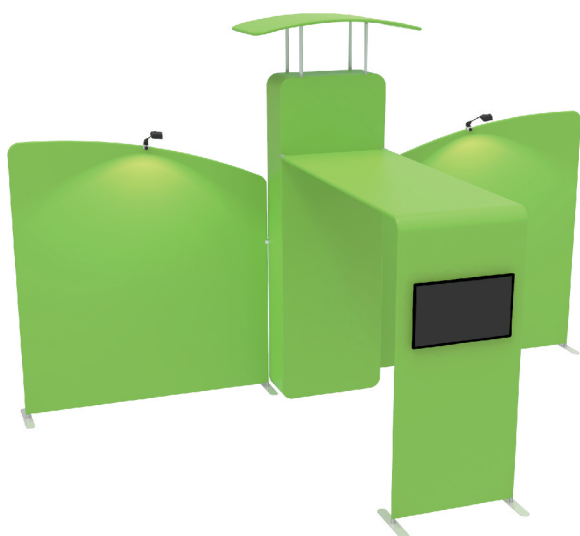

10X20FT-BOOTH-12

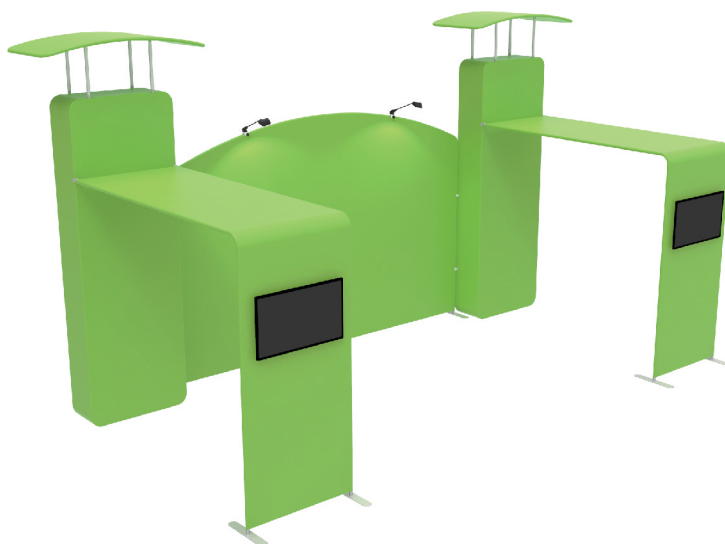

10X20FT-BOOTH-14