

STEPS

(1) Aluminum snap-tube hardware of circular blimp



(2) Aluminum snap-tube hardware of tapered/square quad tower



(3) Screw bags

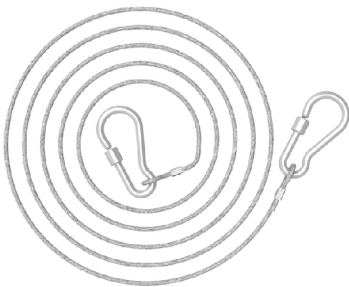

(4) 1x fabric graphic for circular blimp;
1x fabric graphic for tapered/square quad tower

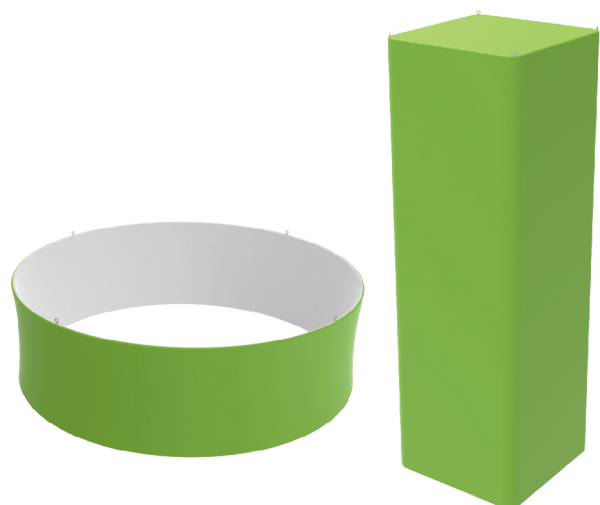

STEPS

STEP 01

To connect the poles according to the labellings then connect to be circle shape

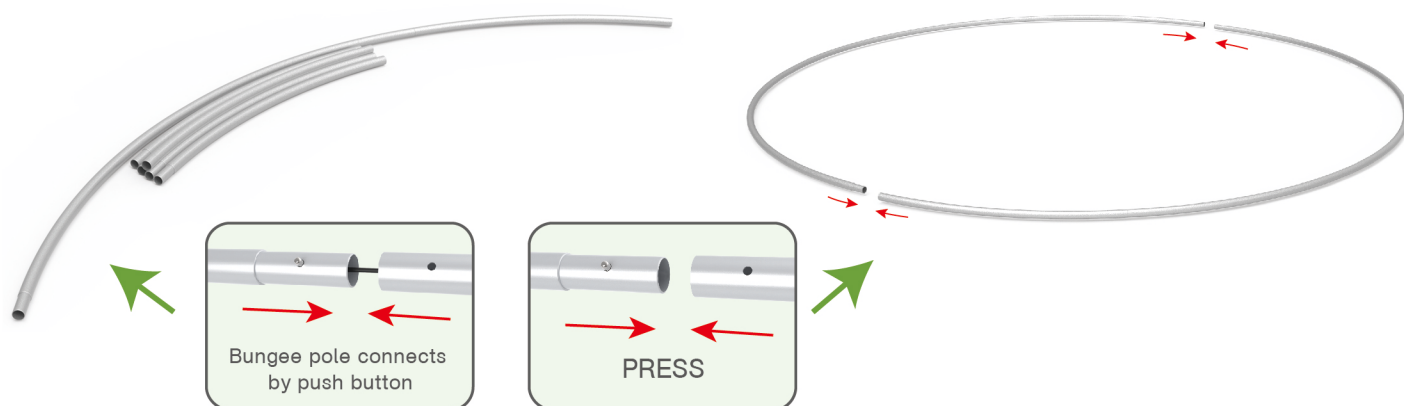

STEP 02

To use screws to install the curved upright poles in position
(Pls mind that screws B are using at the bottom, screws A at the top)

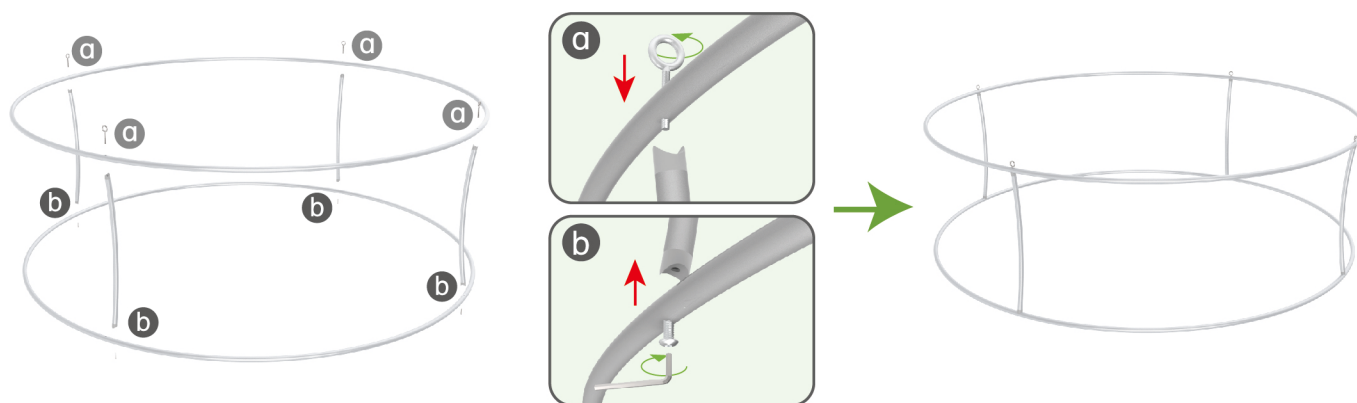

STEP 03

To wrap the fabric banner to the frame from bottom to top and zip up
Pls mind there are holes on fabric for the hanging screws at top of frame.

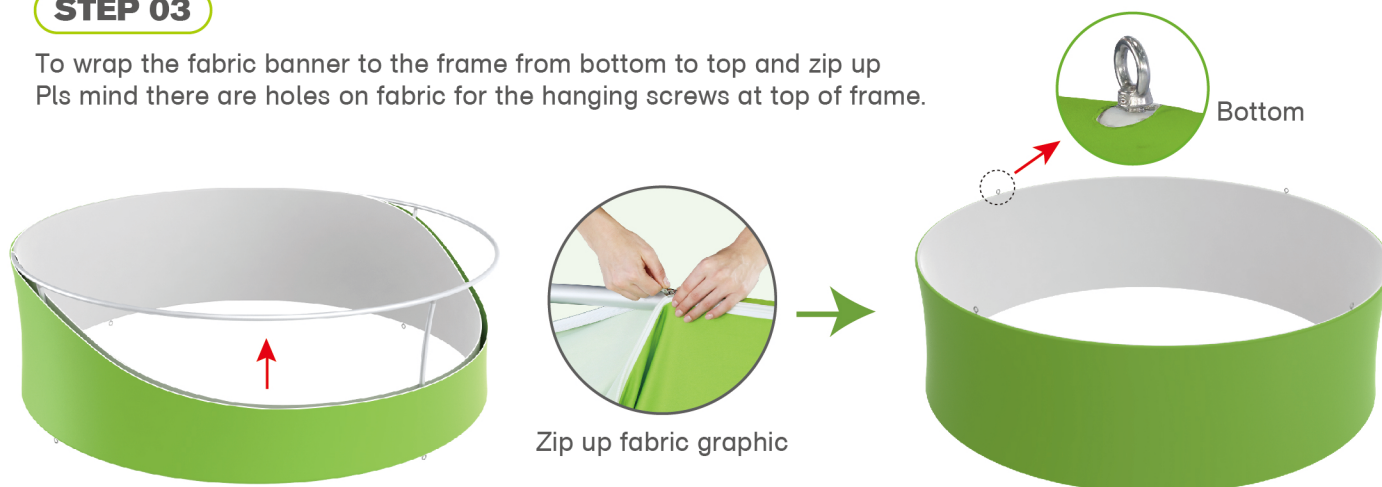

STEPS

STEP 04 To connect the poles according to labellings

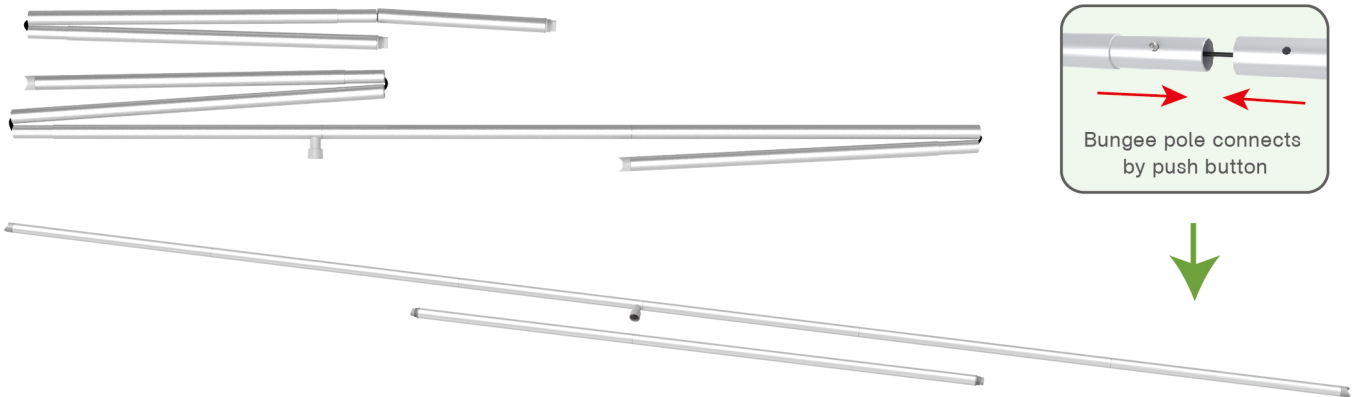

STEP 05 To connect the bottom & top ring by using curved corner pieces according to labellings

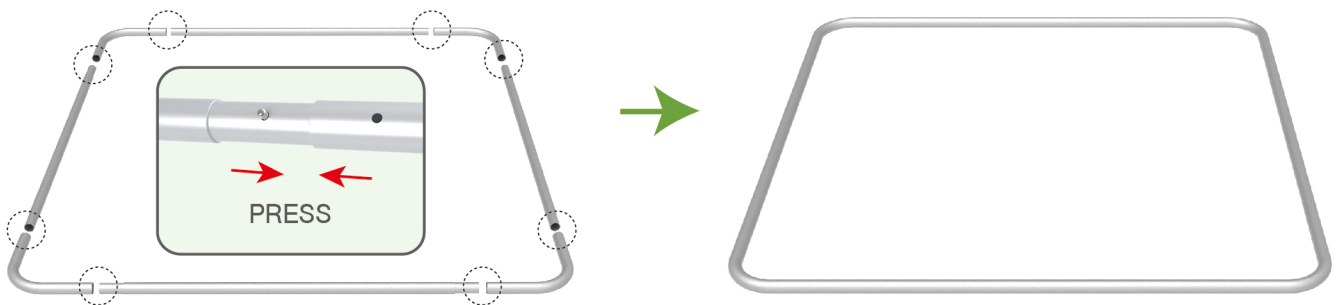

STEP 06

- 1) To connect the long upright pole to the corner of the square ring. (screws A on the bottom square, while screws B on the top square)
- 2) To assemble the cross bars in the middle of tower (see image c)

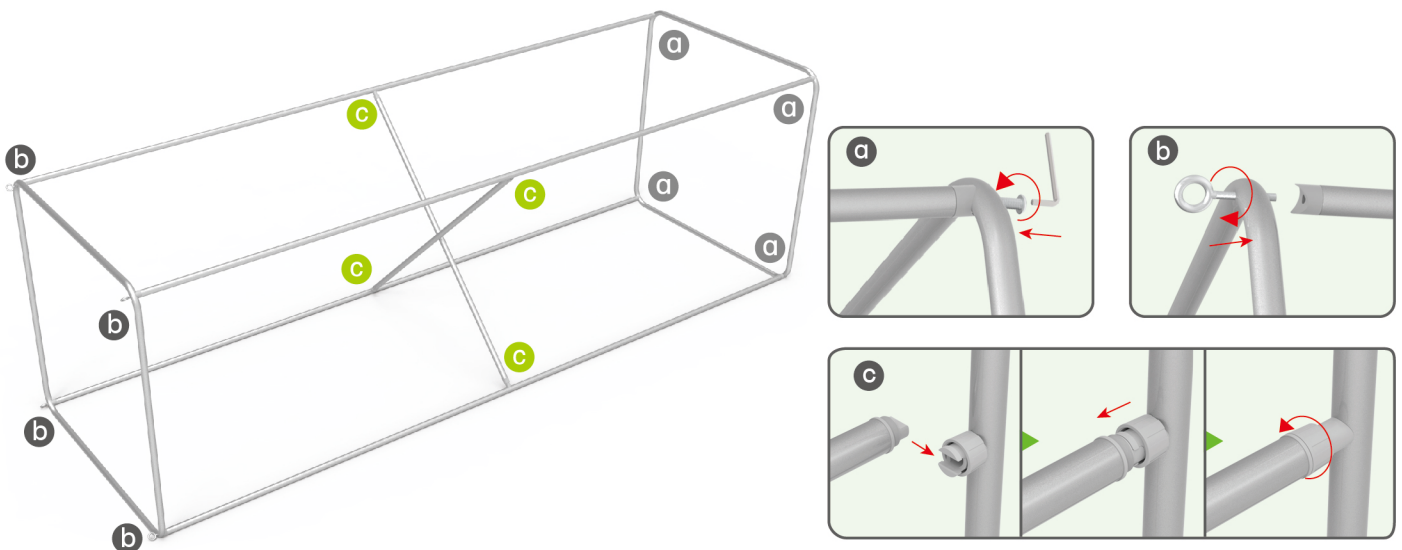

STEPS

STEP 07

To lie down the square quad tower and wrap up the fabric cover from bottom to top and zip up

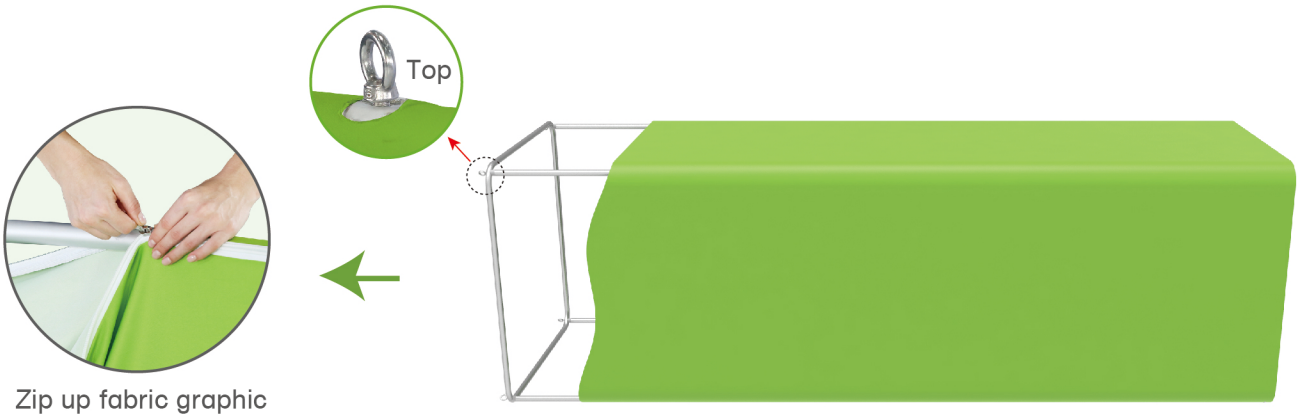

STEP 08

To lie down the square quad tower and install the circular blimp onto top of the square quad tower by using wires, afterwards, lift up the square quad tower & circular blimp at the same time.

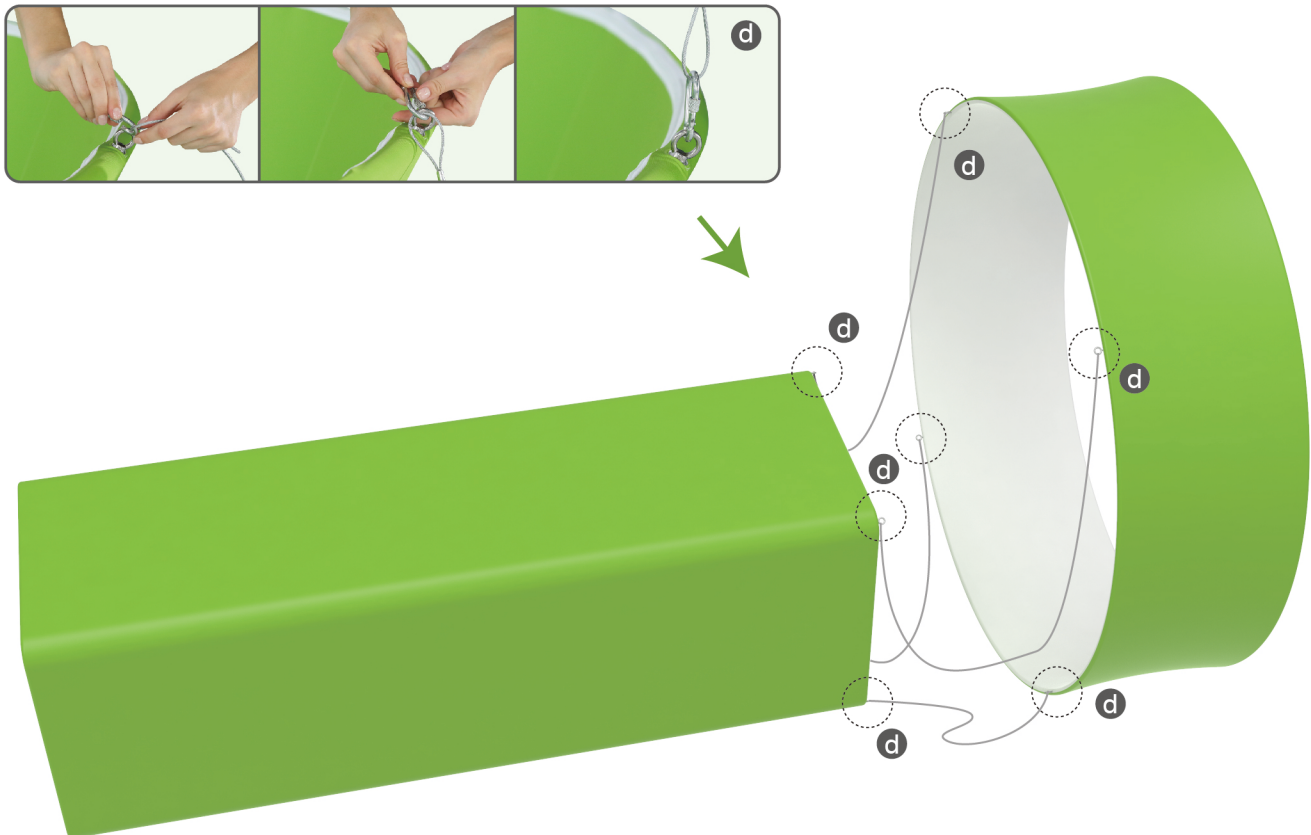

STEPS

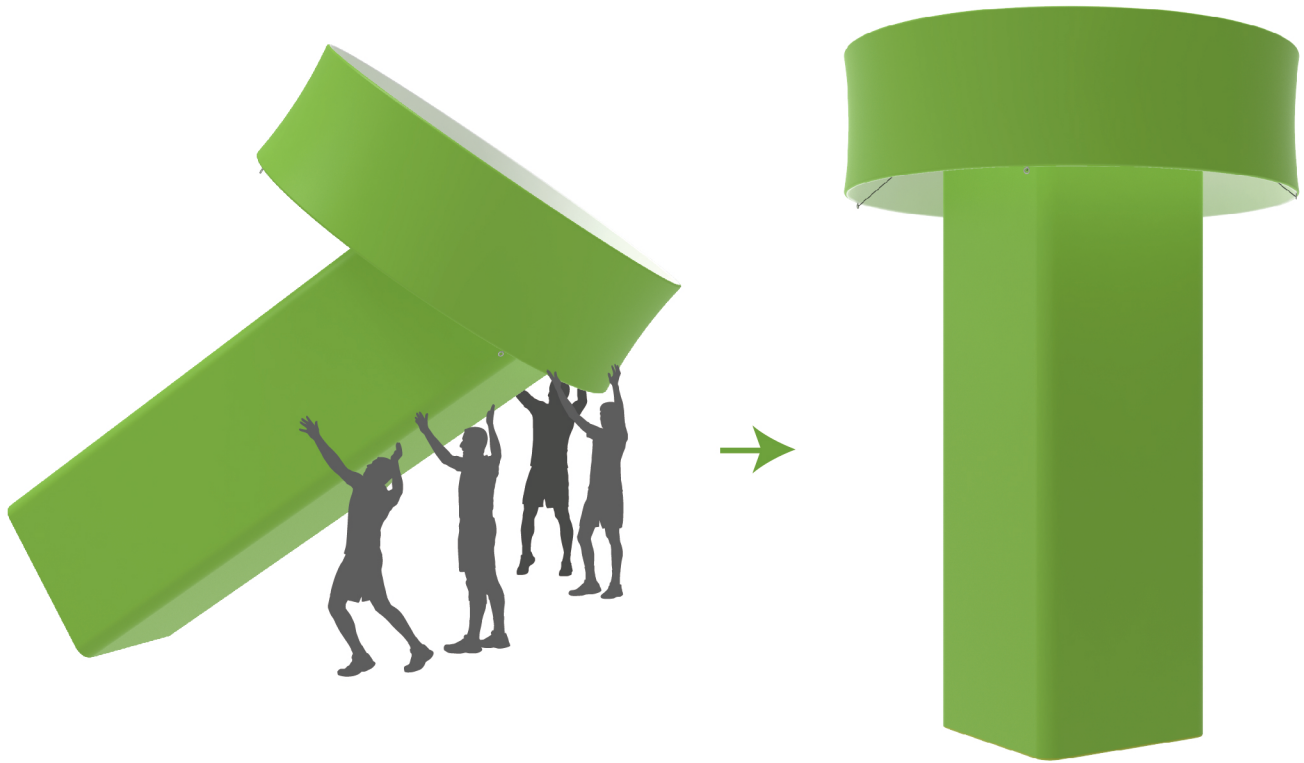

Same Steps for Tapered Quad Tower with Circular Blimp

