

★ One Tool (Hex Wrench) **STEPS**

(1) Hardware

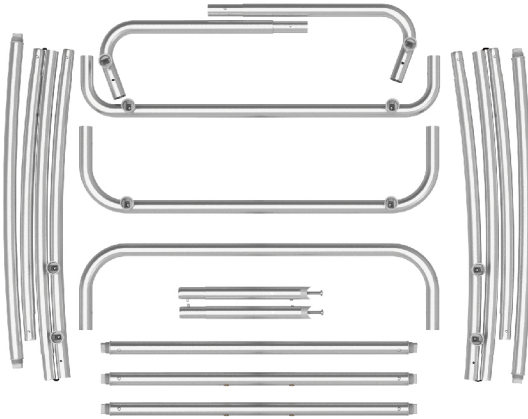

(2) Fabric banner



(3) TV mount &amp; Screw bag

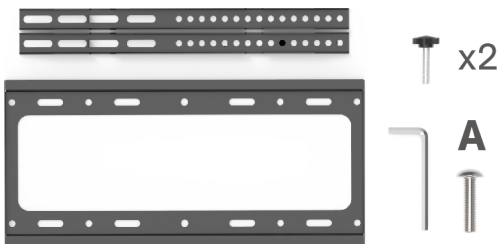

(4) Counter top

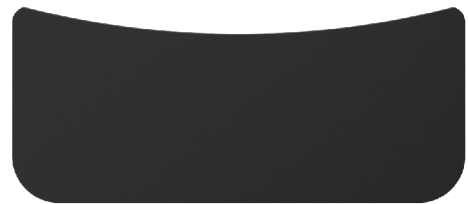
**STEP 01**

To connect the poles according to the labellings

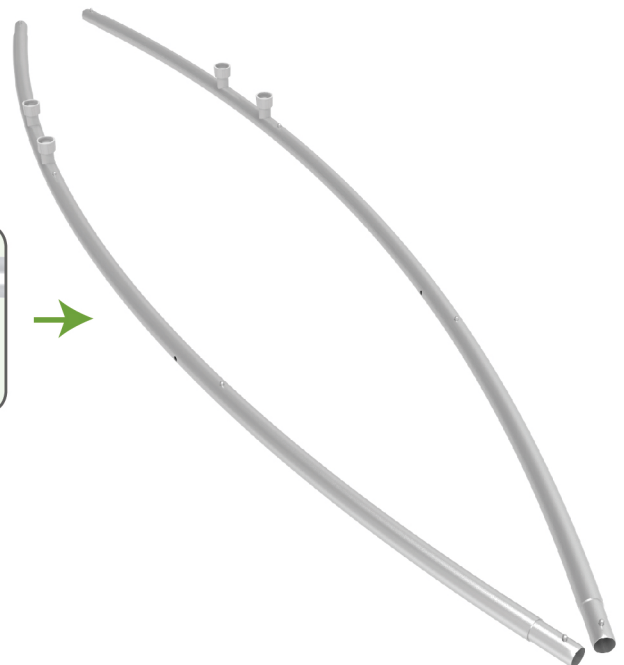
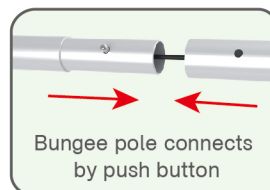

## STEPS

## STEP 02

To connect the poles according to the labellings

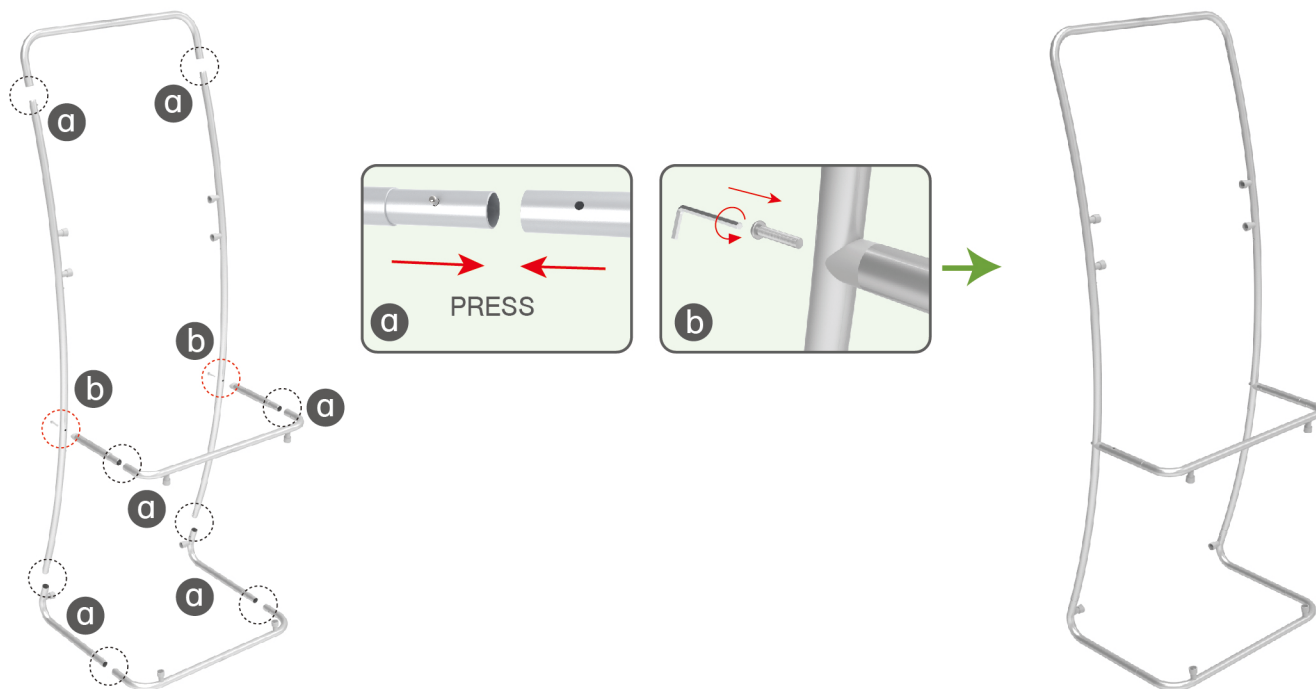

## STEP 03

To install the cross bar in position

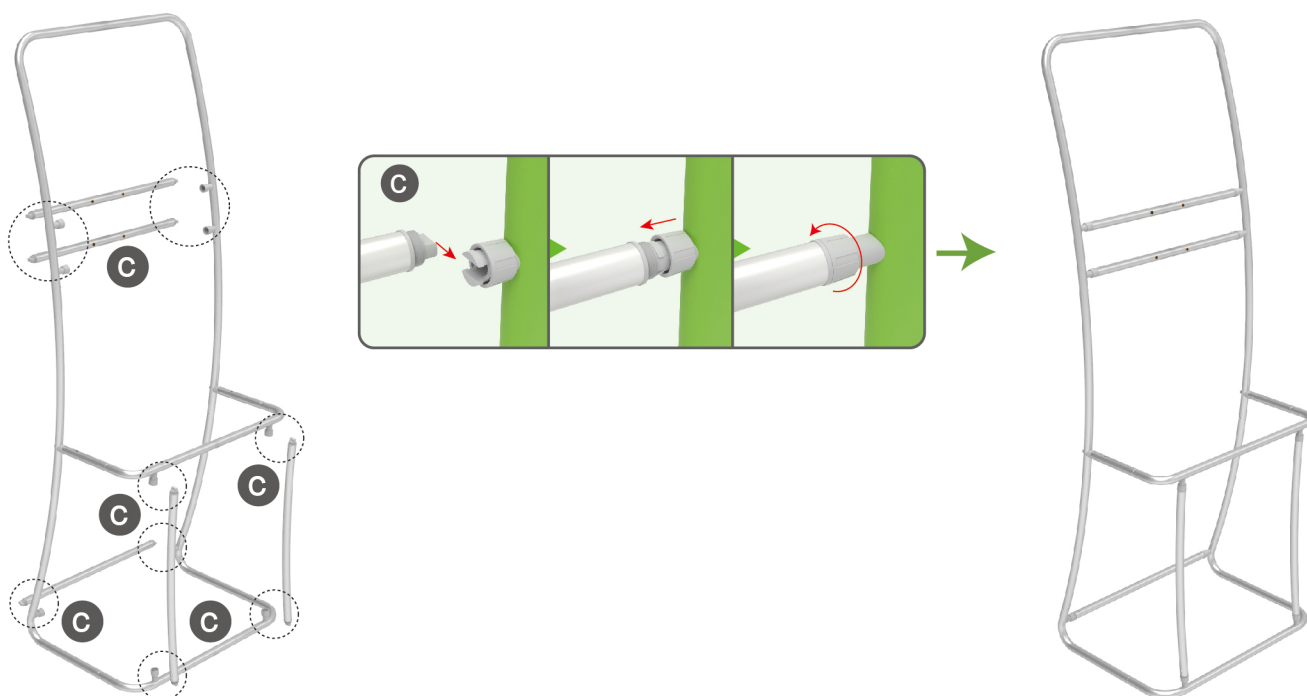

## STEPS

## STEP 04

To wrap the fabric banner from top to bottom and zip up



Zip up fabric graphic



## STEP 05

To put the counter top in position and unzip the zippers at 2 sides and use screw for fastening from bottom

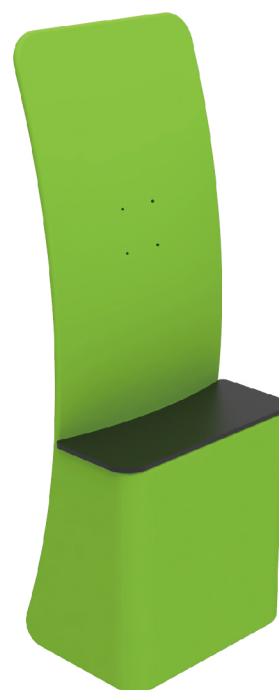
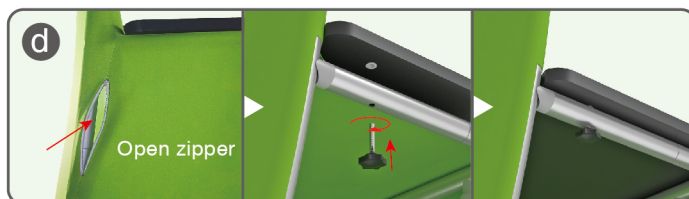
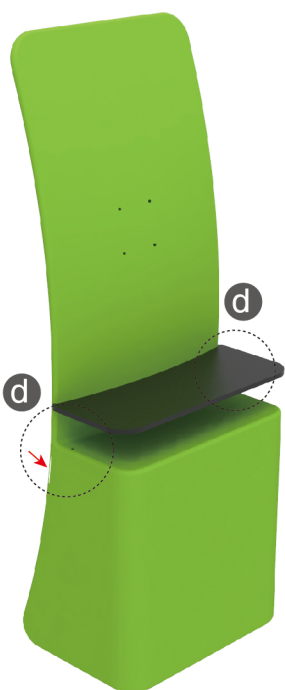

## STEPS

## STEP 06

To install the TV mount

