

STEPS

(1) Hardware



(2) Printed Graphic Fabric Banner (Optional)



STEP 01

Interconnect aluminum profile by pulling up buckle to insert into & pressing down to lock.

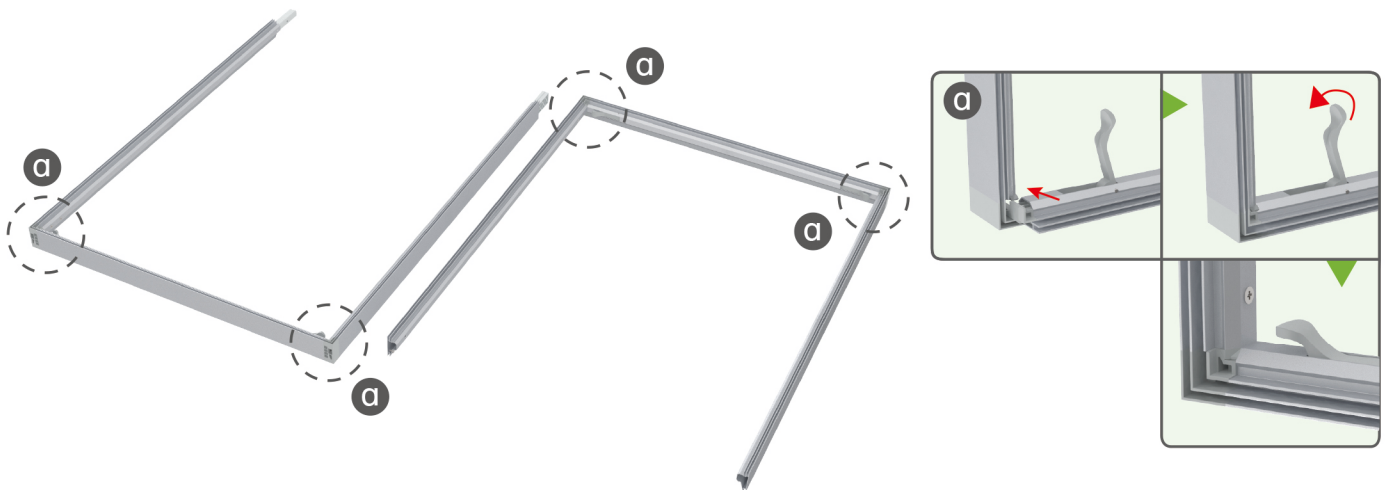

STEP 02

Insert interconnected aluminum profile onto feet.

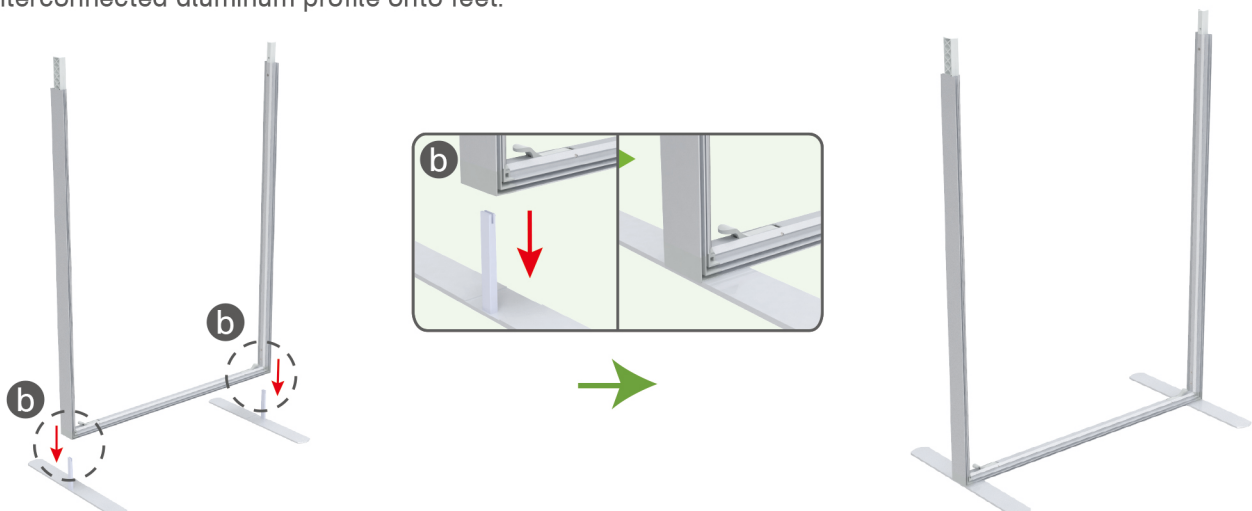

STEPS

STEP 03

Interconnect upper & lower parts, align upper part's hole to install support rod.

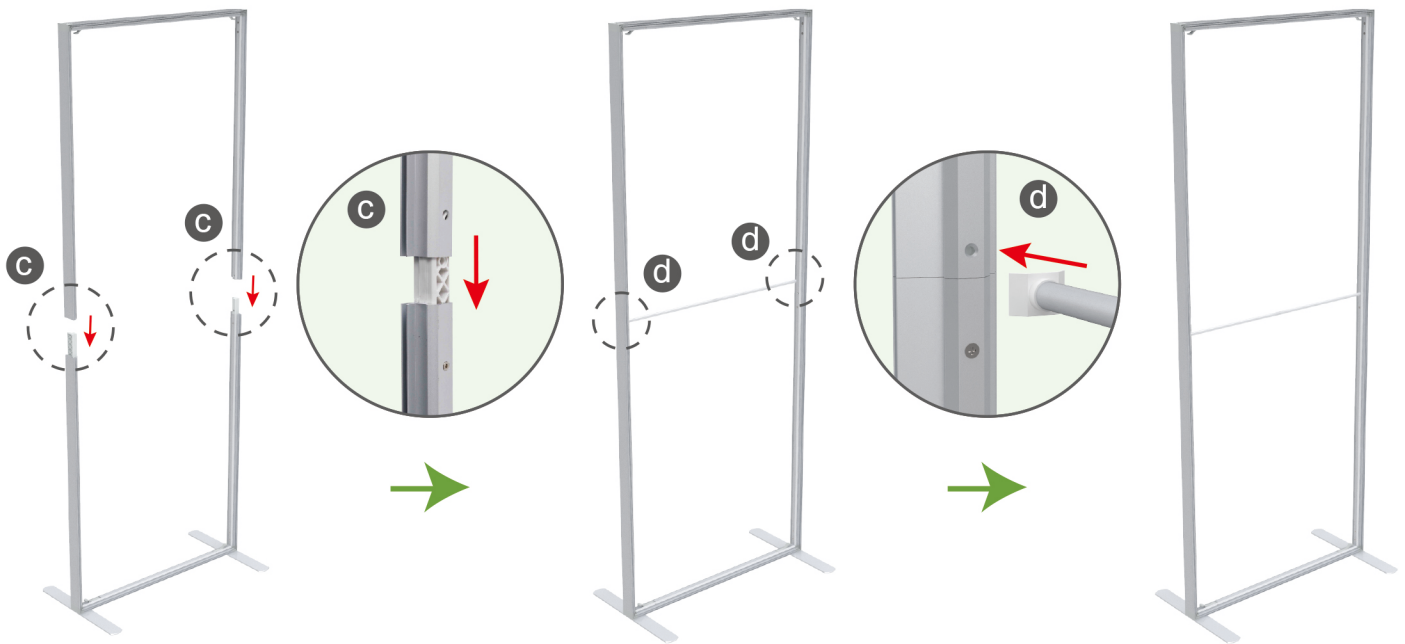

STEP 04

Insert silicone edge graphic pieces into channels from corners. (Same Steps for Double Sides)

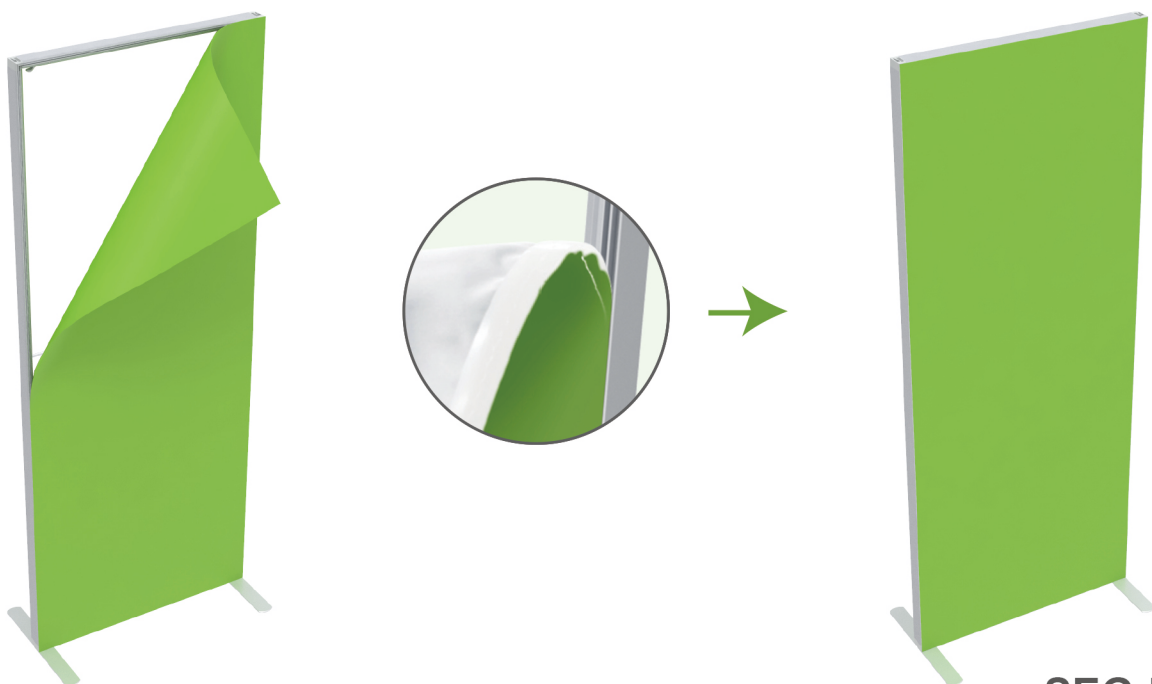

SEG-B-01