

## STEPS

## (1) Hardware

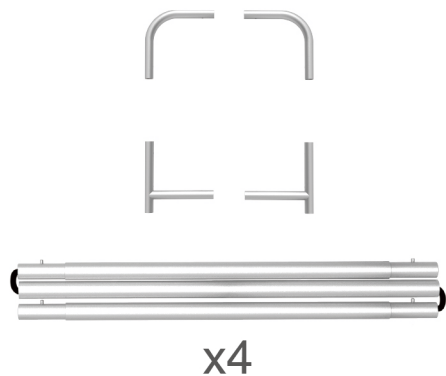

## (2) Printed Graphic Fabric Banner



## STEP 01

Connect to make long poles according to labelings.

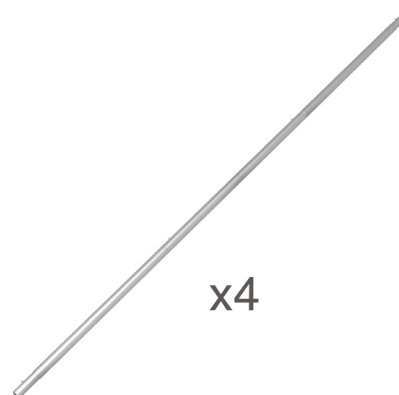
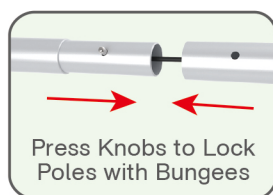
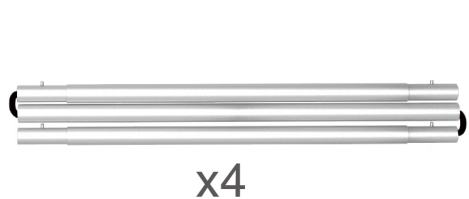

## STEP 02

Connect long poles with corner poles according to labelings.

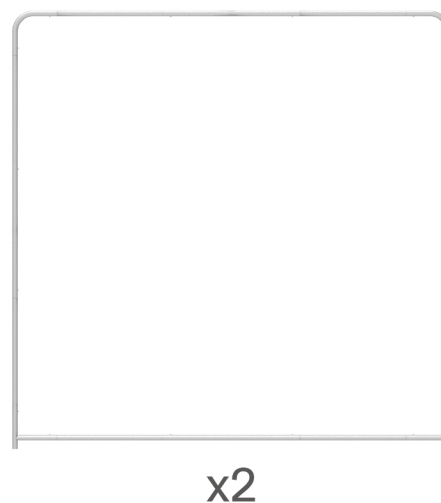
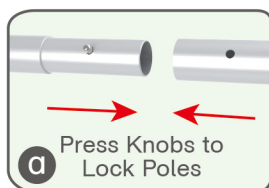
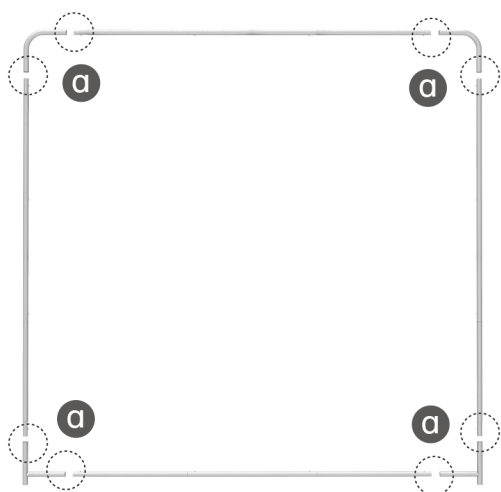

## STEPS

**STEP 03** Slide fabric banner on frame from top and zip up at bottom.

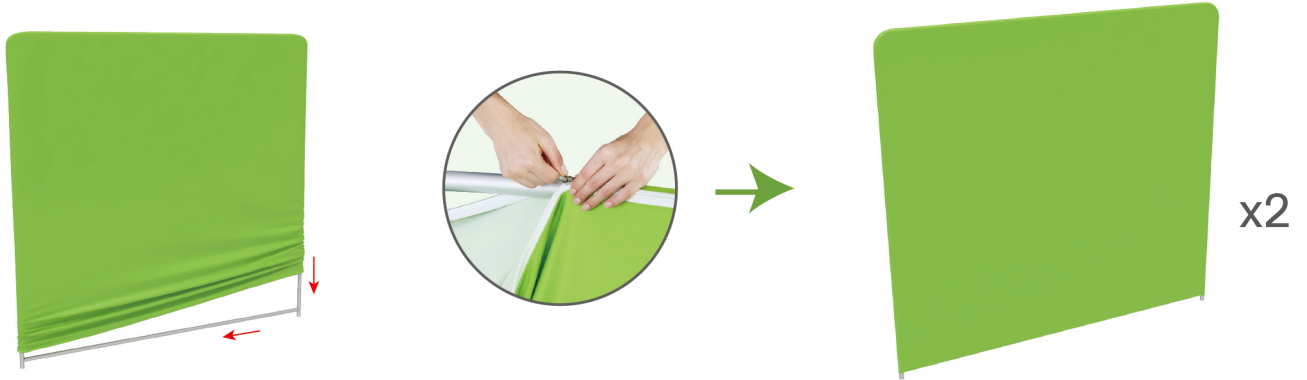

(1) Hardware

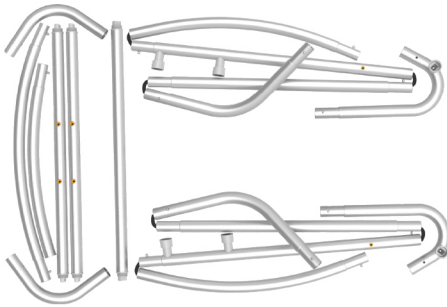

(2) Printed Graphic Fabric Banner



**STEP 01** Connect to make long poles according to labelings.

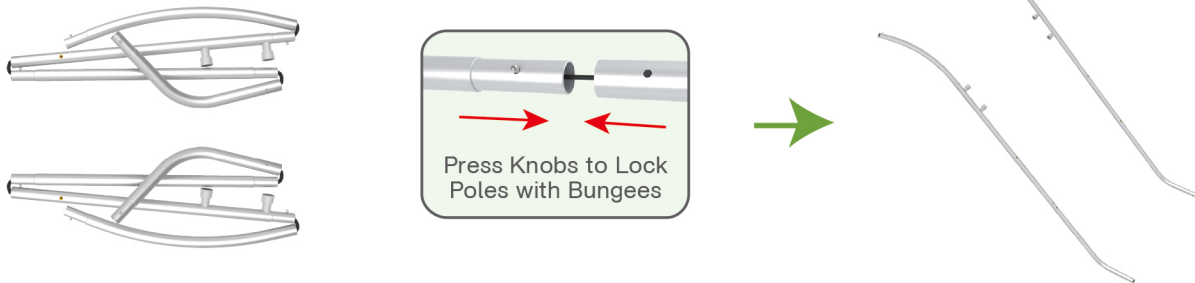

**STEP 02** Connect long poles with corner poles according to labelings.

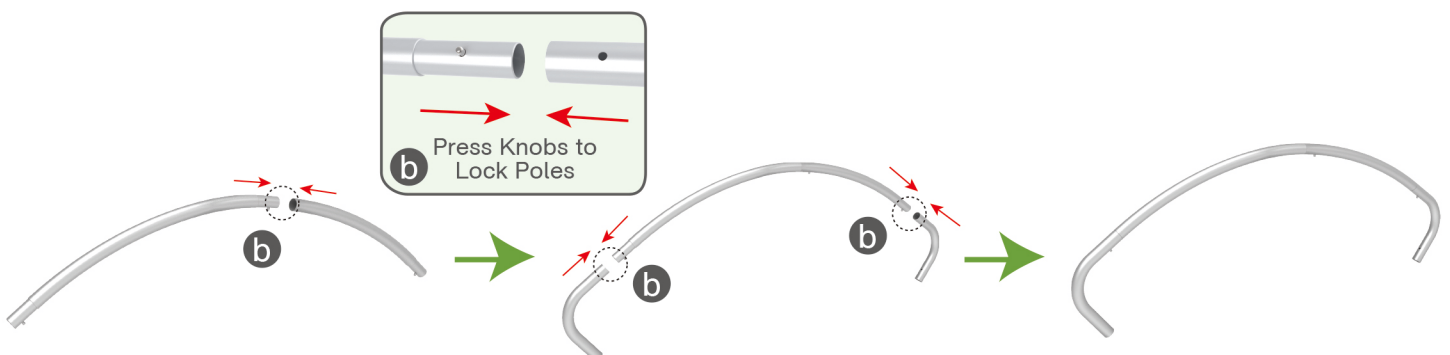

★ One Tool (Hex Wrench)

## STEPS

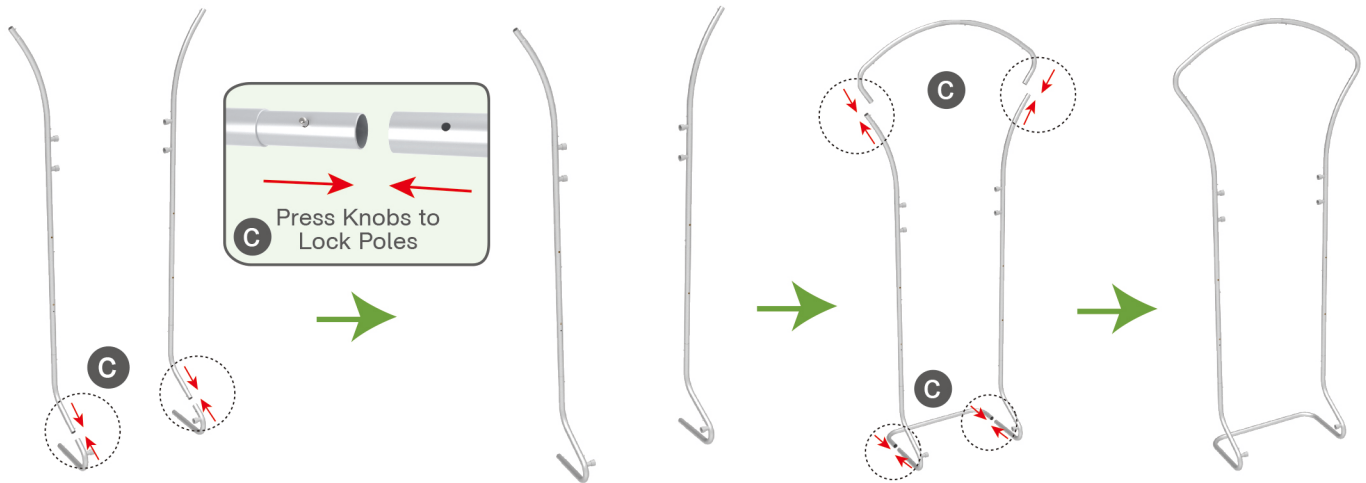
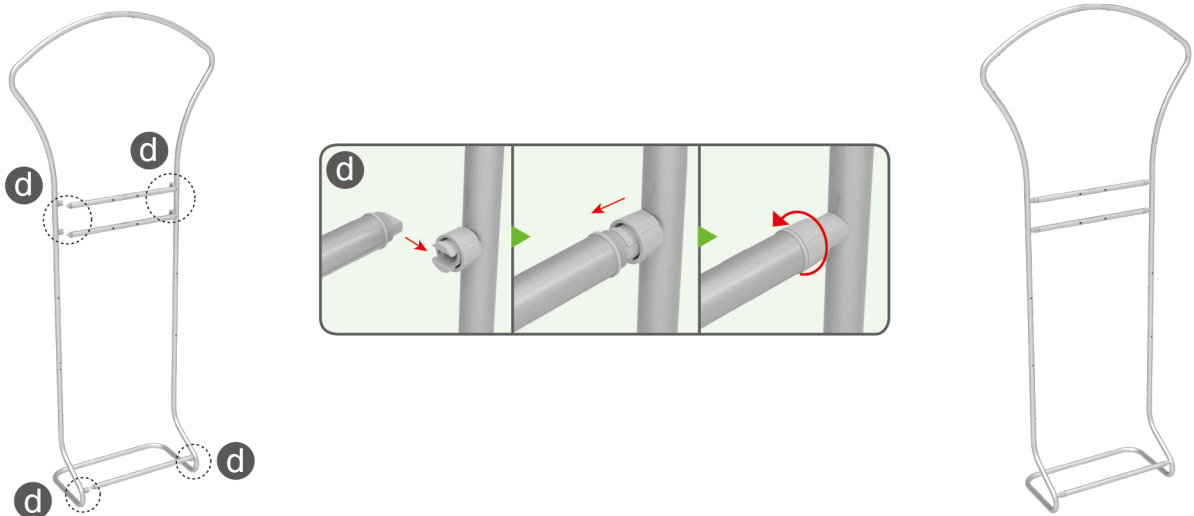
**STEP 03** Install cross bars in position.**STEP 04** Slide fabric banner on frame from bottom and zip up at top.

## STEPS

## Booth Set Assembly



(1) Base

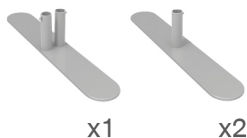

(2) LED Light &amp; Clip



(3) S-Shaped Clip



(4) Shelf &amp; Bracket



(5) C-Shaped Clip &amp; TV Mount

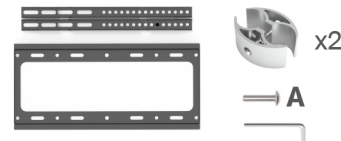

## STEP 01

Insert display stands onto feet by pressing their knobs.

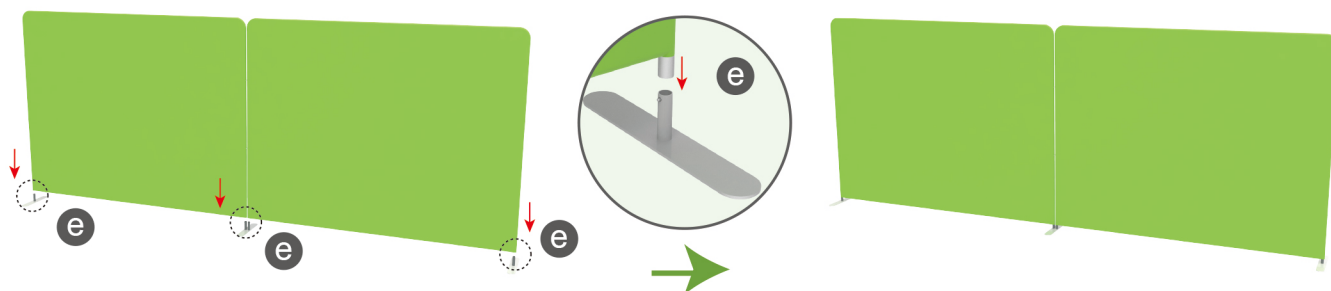

## STEP 02

Interconnect display stands with C-shaped clips.

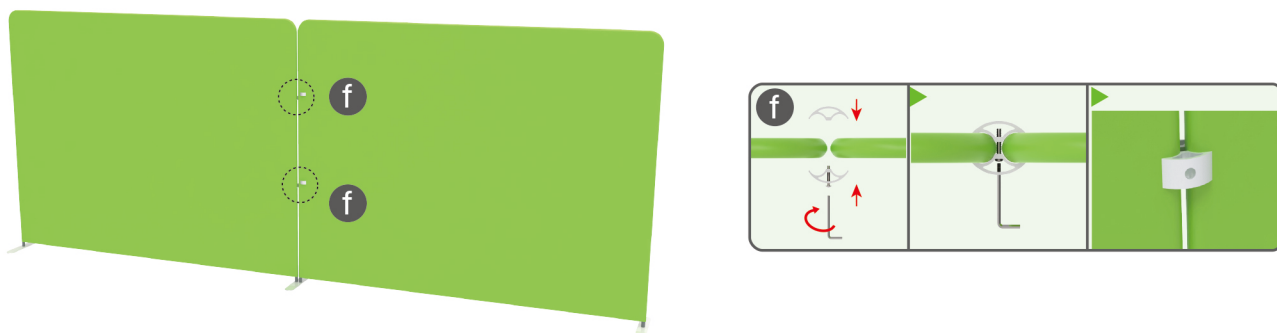

## STEP 03

Clamp display stands with S-shaped clips.

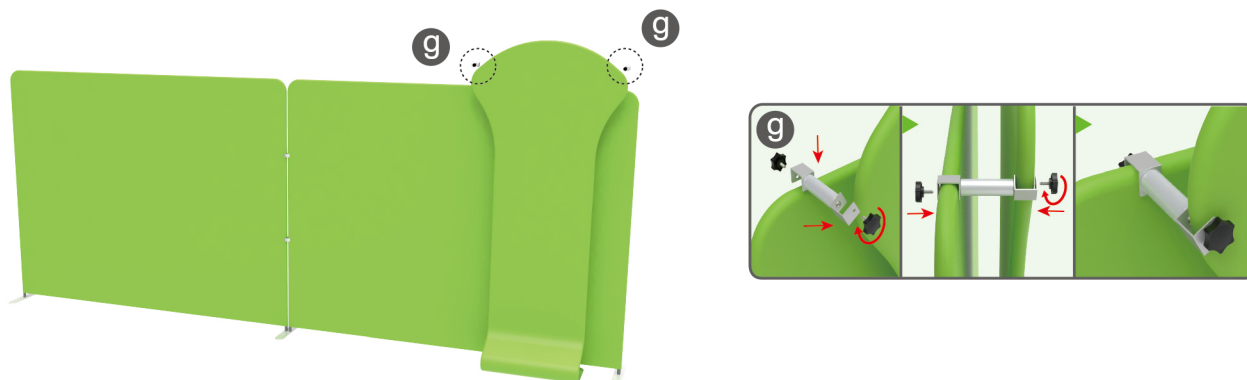



## STEPS

## STEP 04

Screw brackets onto display stand with hex wrench, insert shelves into slots.

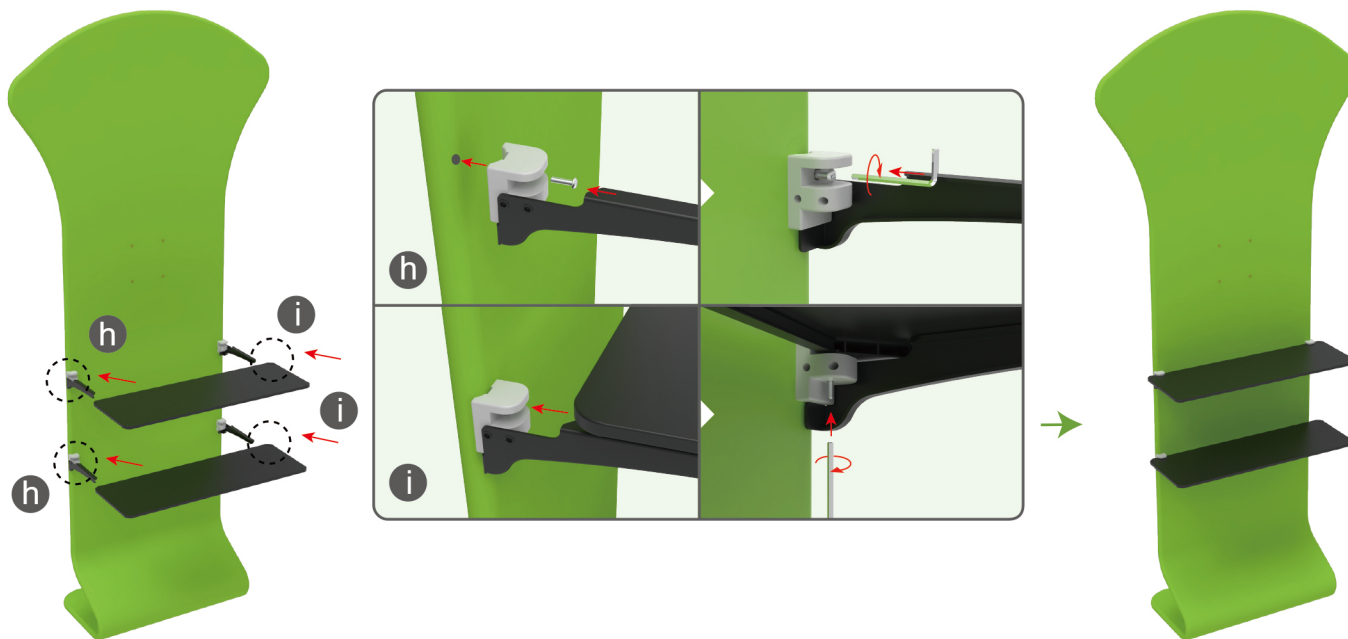

## STEP 05

Screw TV mount onto display stand & support brackets onto TV's back with hex wrench, hang TV onto mount & screw.

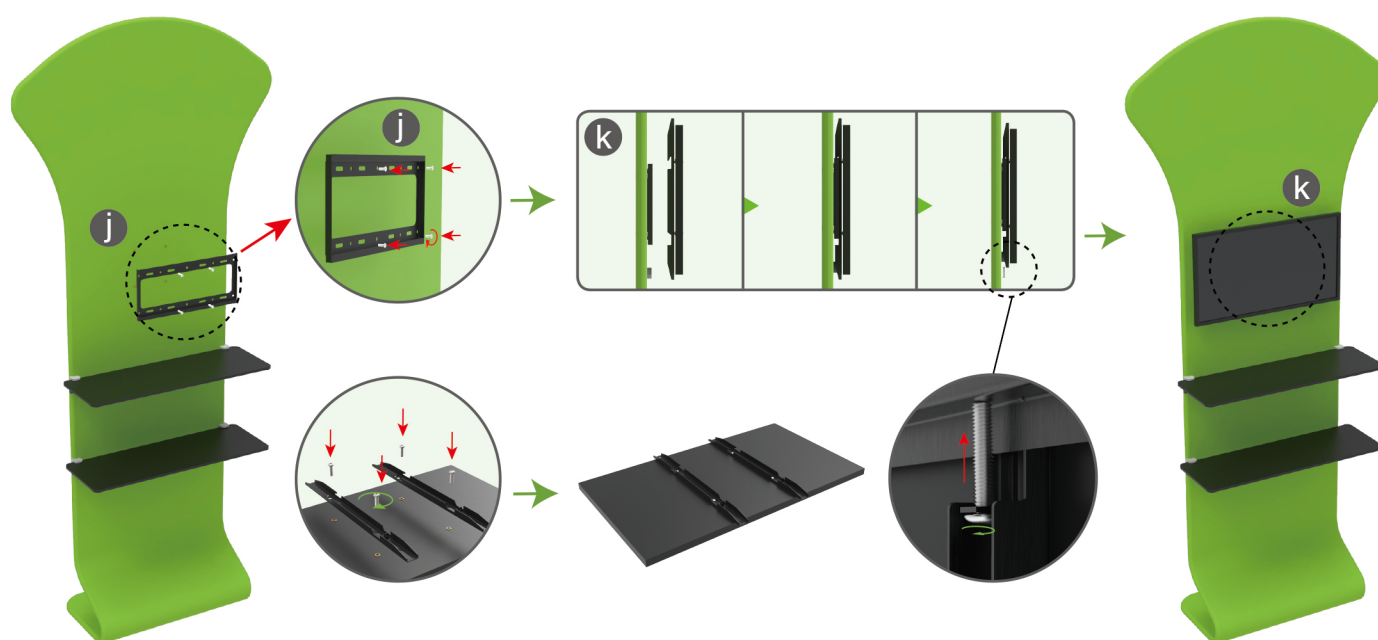

## STEPS

**STEP 06** Screw light clips at top of display stands, slide lights onto them and adjust their direction.

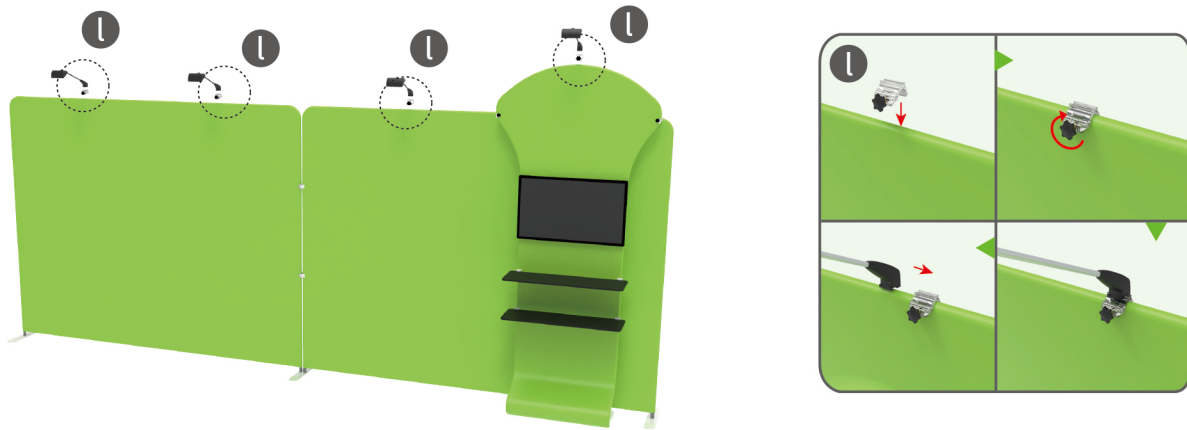

10X20FT-BOOTH-N



10X10FT-BOOTH-I

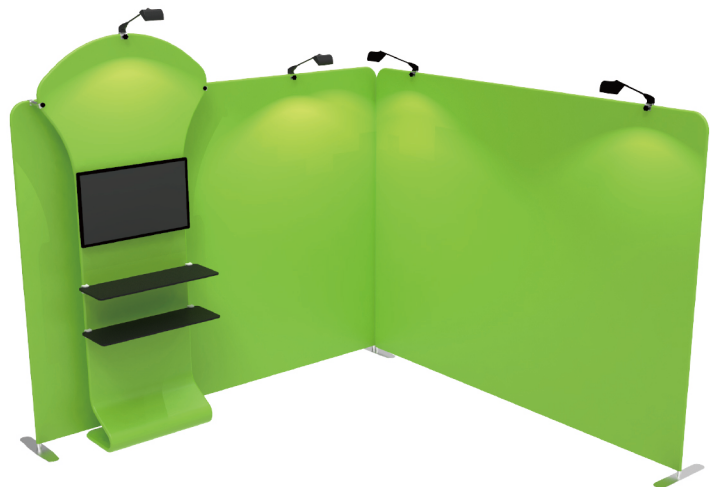

10X10FT-BOOTH-Z