

STEPS

(1) Hardware

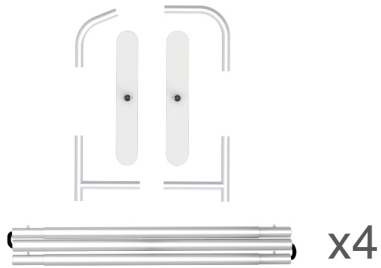
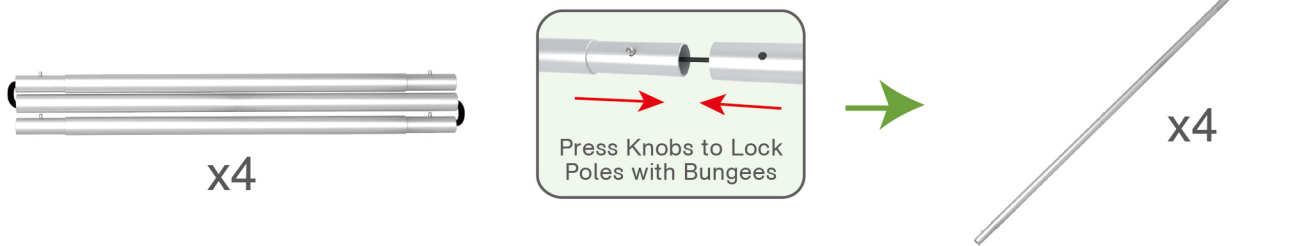
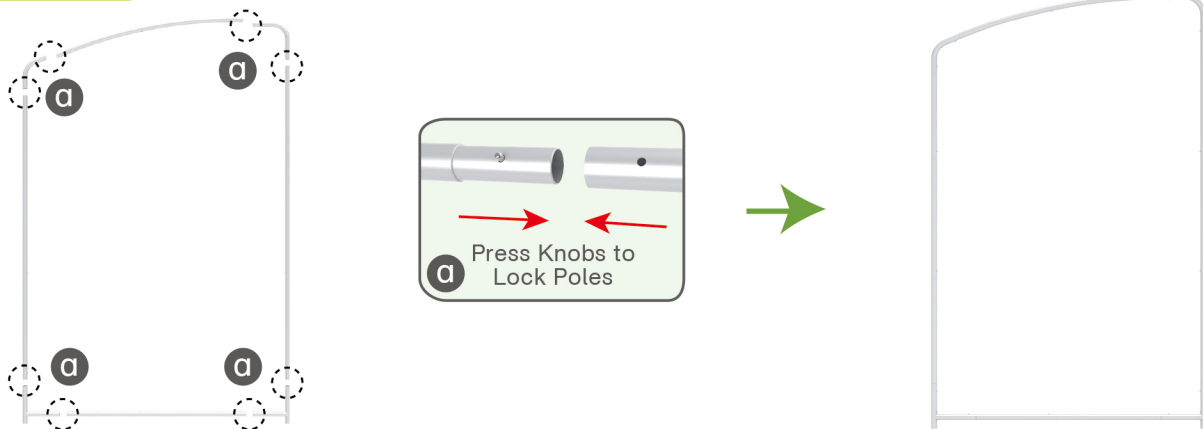

(2) Printed Graphic Fabric Banner

**STEP 01** Connect to make long poles according to labelings.**STEP 02** Connect long poles with corner poles according to labelings.**STEP 03** Slide fabric banner on frame from top and zip up at bottom.

STEPS

(1) Hardware

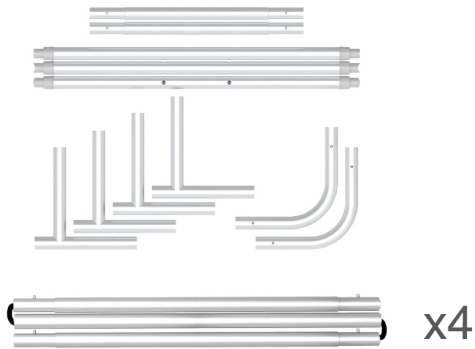

(2) Printed Graphic Fabric Banner



STEP 01

Connect to make long poles according to labelings.

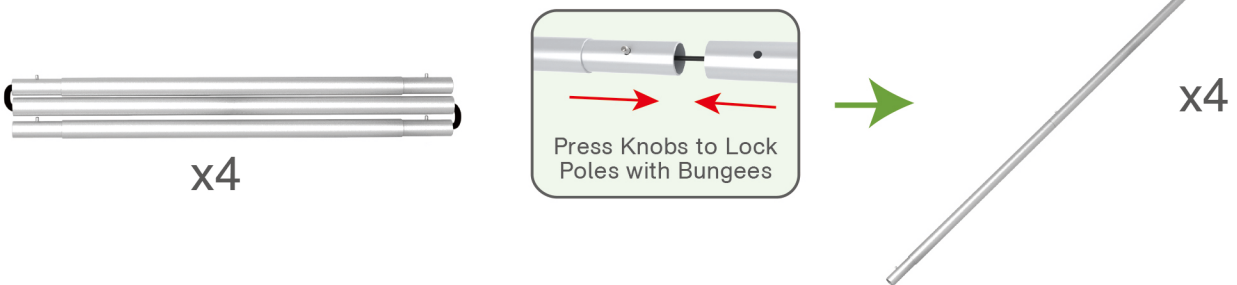

STEP 02

Connect long poles with corner poles according to labelings.

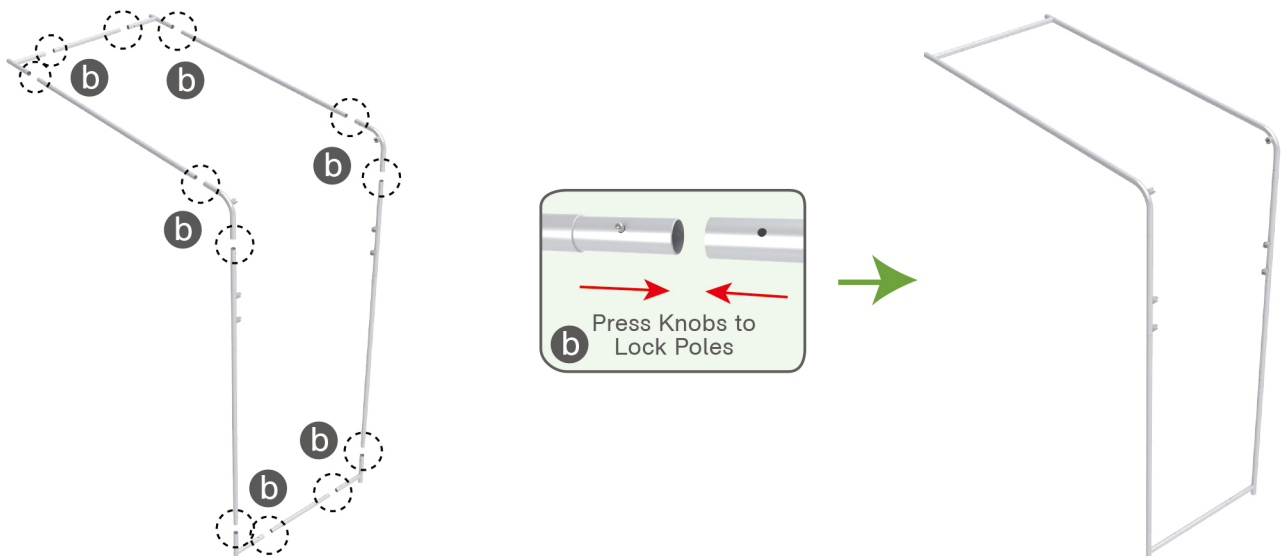

STEPS

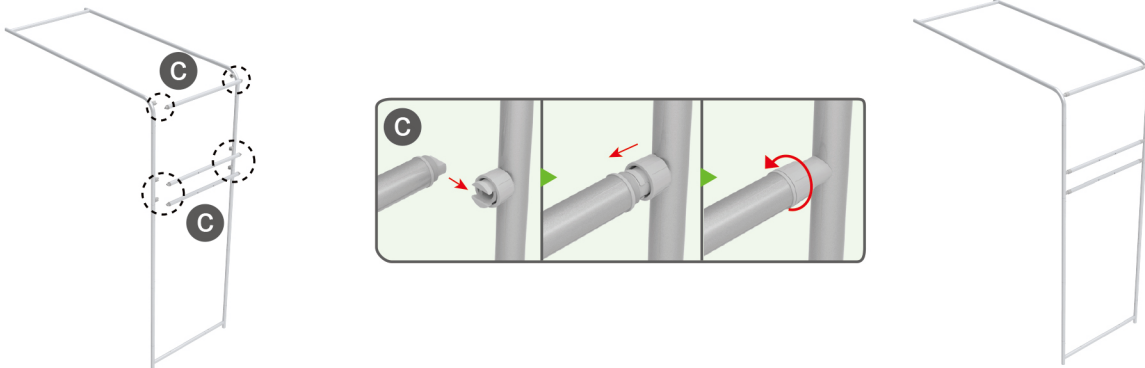
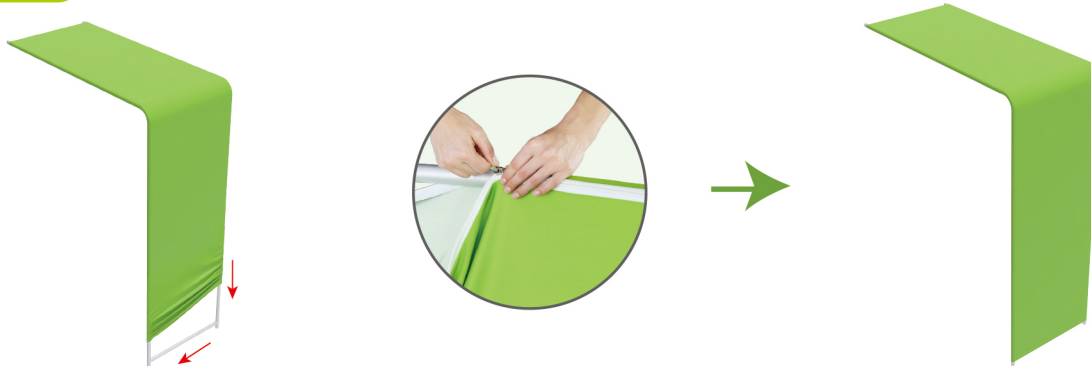
STEP 03 Install cross bars in position.**STEP 04** Slide fabric banner on frame from top and zip up at bottom.

Booth Set Assembly

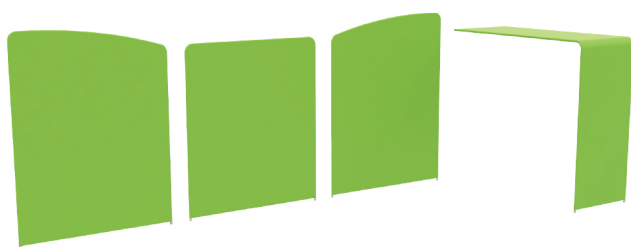

(1) Base

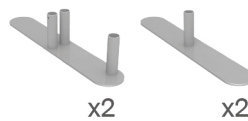

(2) C-Shaped Clip & TV Mount

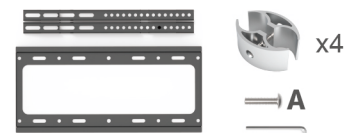

(3) MDF Board Table & Arm Clip

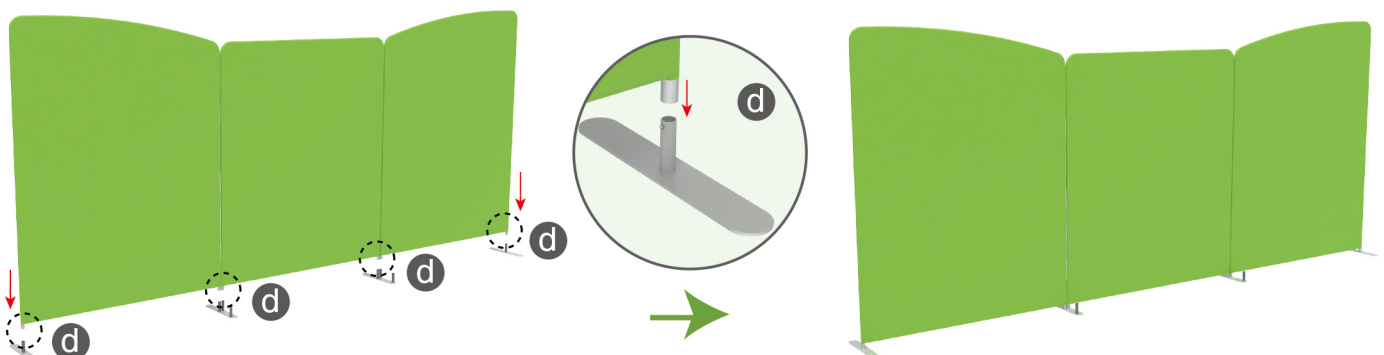

(4) LED Light & Clip

**STEP 01** Insert display stands onto feet by pressing their knobs.

STEPS

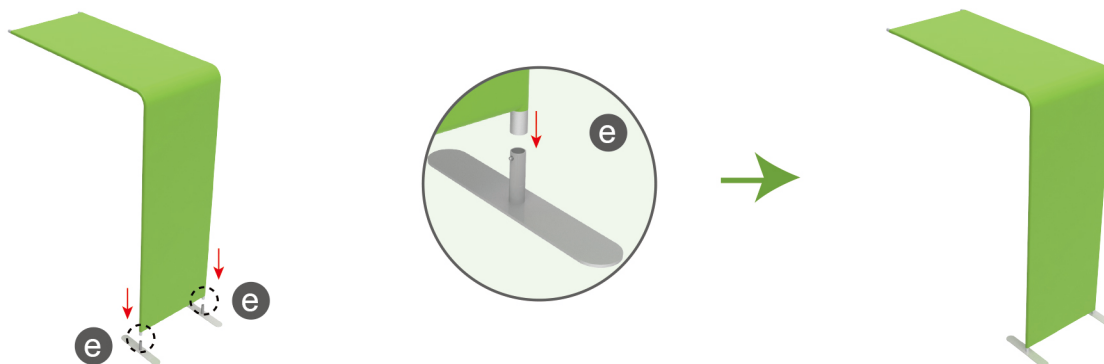

STEP 02 Interconnect display stands with C-shaped clips.

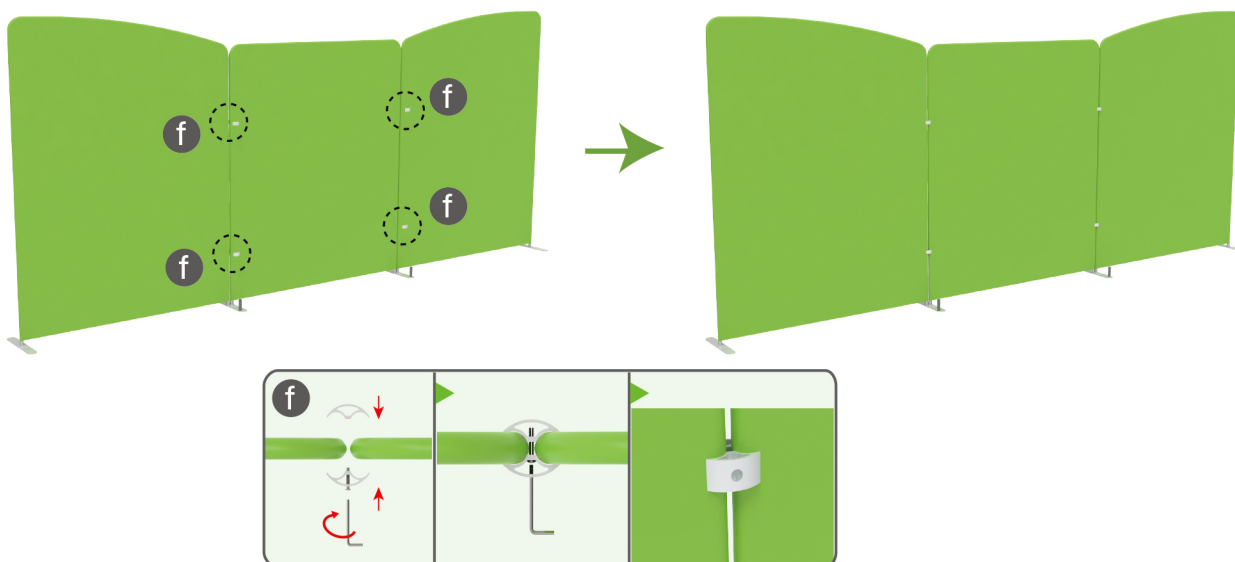

STEP 03 Connect display stands with arm clips.

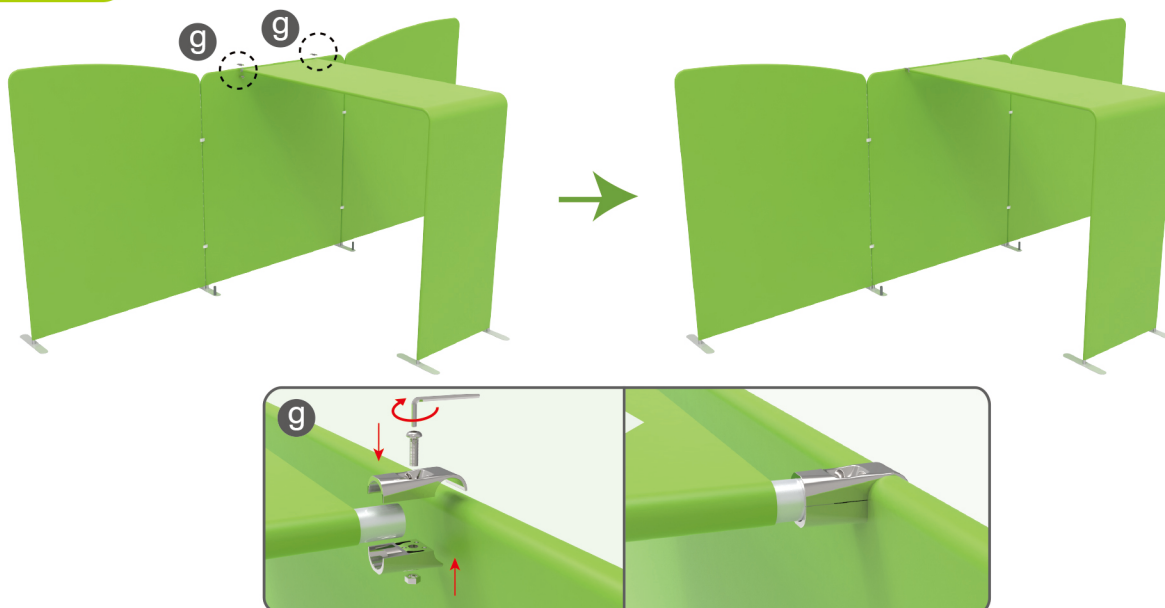

STEPS

STEP 04

Insert pole into base, screw clamp with hex wrench, place MDF board onto pole & insert into clamp with screw.

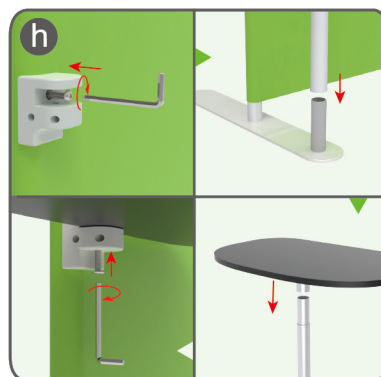
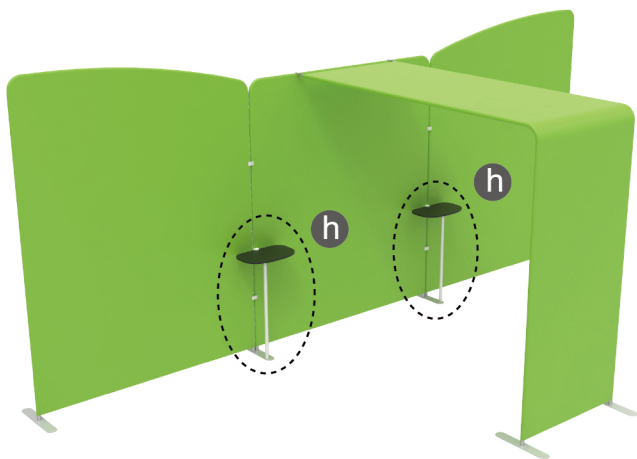

STEP 05

Screw TV mount with hex wrench.

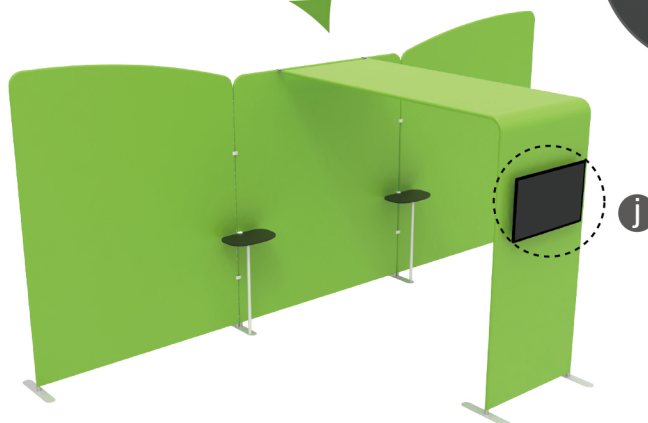
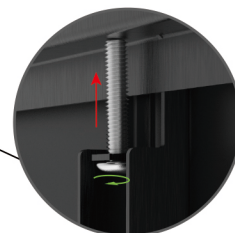
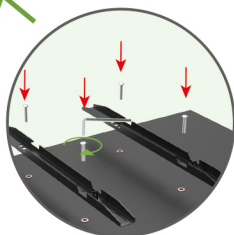
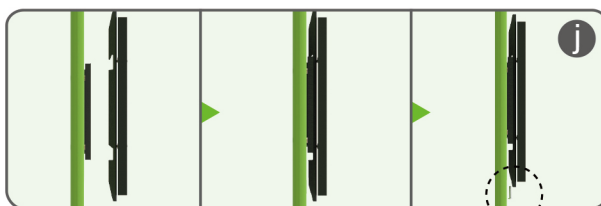
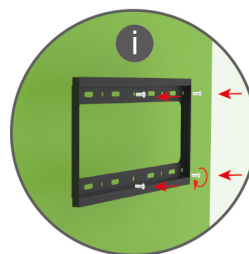
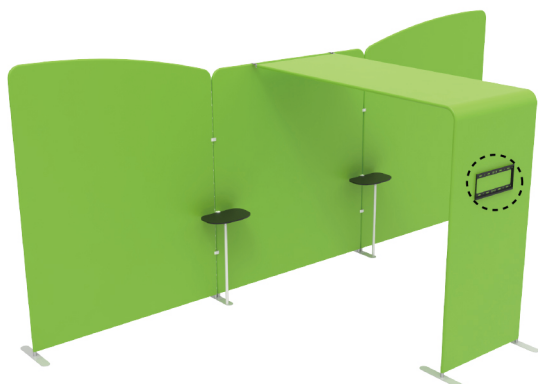

STEPS

STEP 06 Screw light clips at top of display stands, slide lights onto them and adjust their direction.

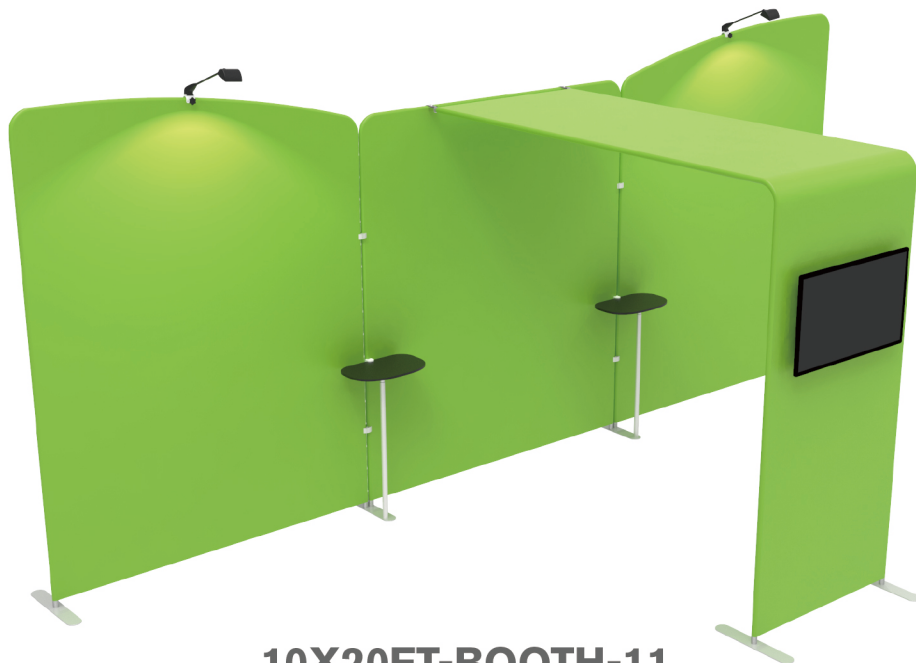
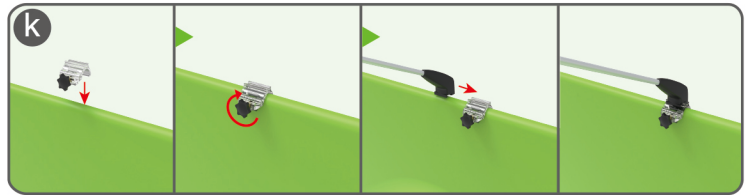
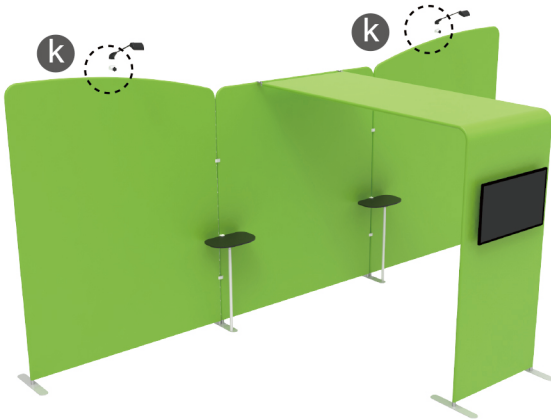

10X20FT-BOOTH-11

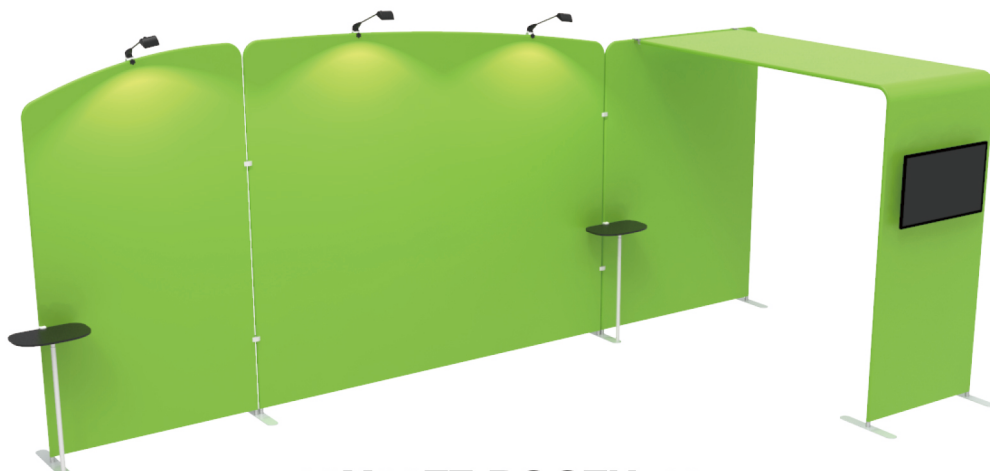

10X20FT-BOOTH-10